

# Concept Design Options

*Central Artery/Tunnel Parcel 2 Park Design  
Meeting 3 - October 2, 2019*



**boston planning &  
development agency**

## ***Project Team / Schedule***

*Public Process to Date: Site History & Analysis*

*Design Workshop Feedback*

*Concept Design Options*

---

# Project Team



**boston planning &  
development agency**

## **Kennan Rhyne**

Senior Planner II, Project  
Manager & Contact Person

## **Lauren Shurtleff**

Acting Director of Planning

## **Jill Zick**

Landscape Architect



## **John Romano**

Director of the Office of  
Outdoor Advertising



## **Jesse Brackenbury**

Executive Director

## **Rebecca McKevez**

Capital Projects Manager

## **Rachel Lake**

Marketing & Community  
Affairs Manager

**ASK +**

**Unknown  
Studio**

## **Sara Cohen**

Principal & Project Manager,  
ASK+

## **Claire Agre**

Design Principal,  
Unknown Studio

## **Meg Baldwin**

Landscape Designer,  
Unknown Studio



# Project Timeline

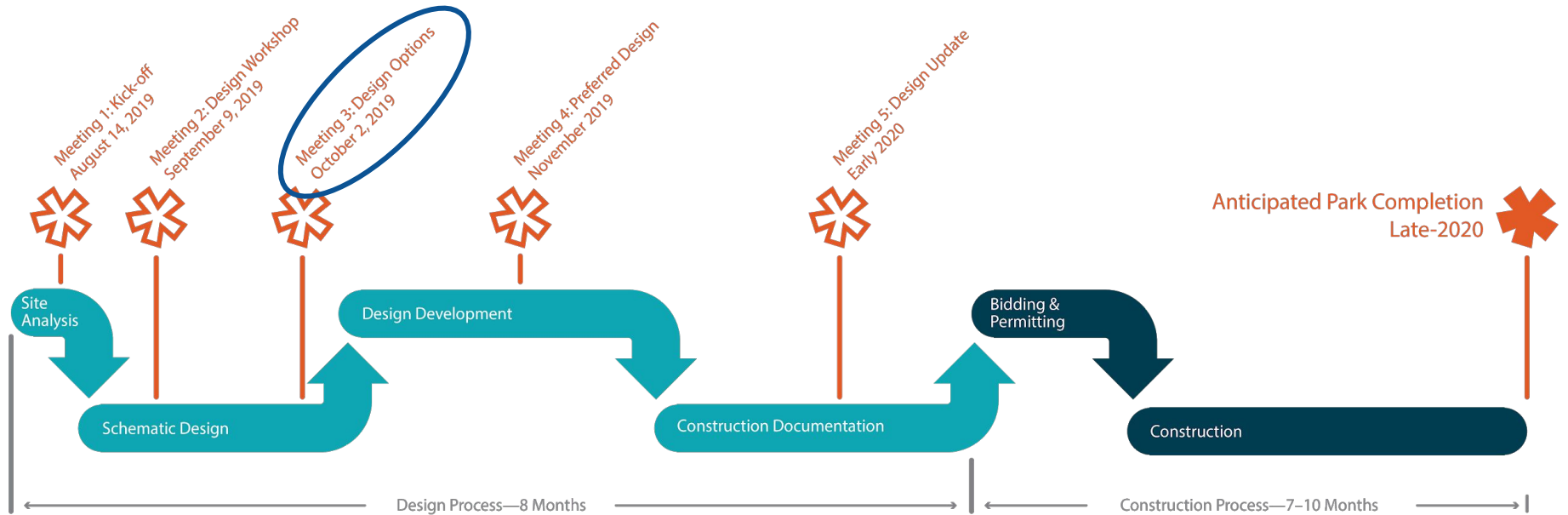



**boston planning &  
development agency**

*Project Team / Schedule*

***Public Process to Date: Site History & Analysis***

*Design Workshop Feedback*

*Concept Design Options*

---



**boston planning &  
development agency**

## *Site History*

---

1796



A plan of Boston, Osgood Carleton ; S. Hill, sc., 1796.

1814

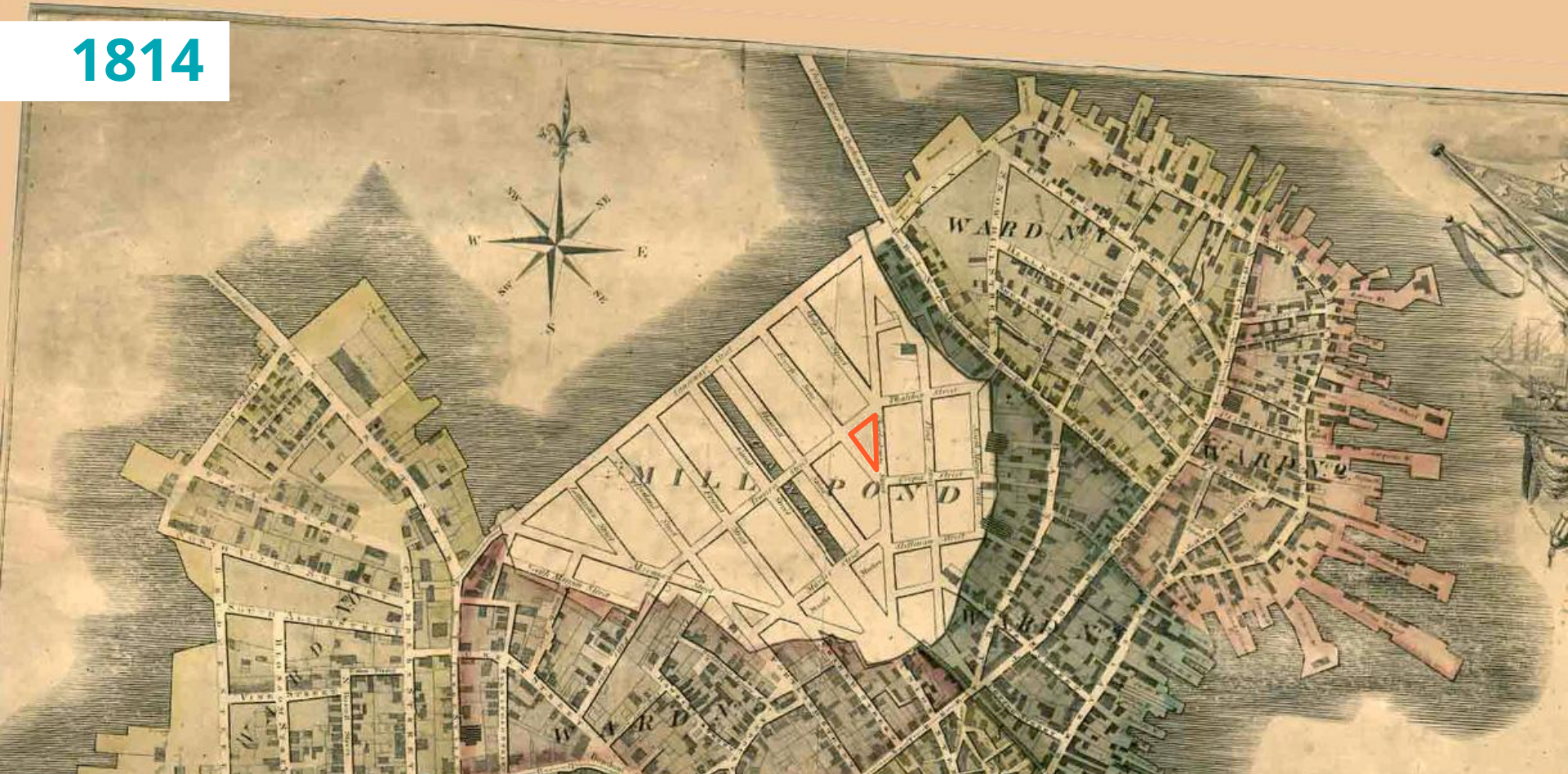

Map of Boston in the State of Massachusetts, Hales, J.G., 1814.



1867

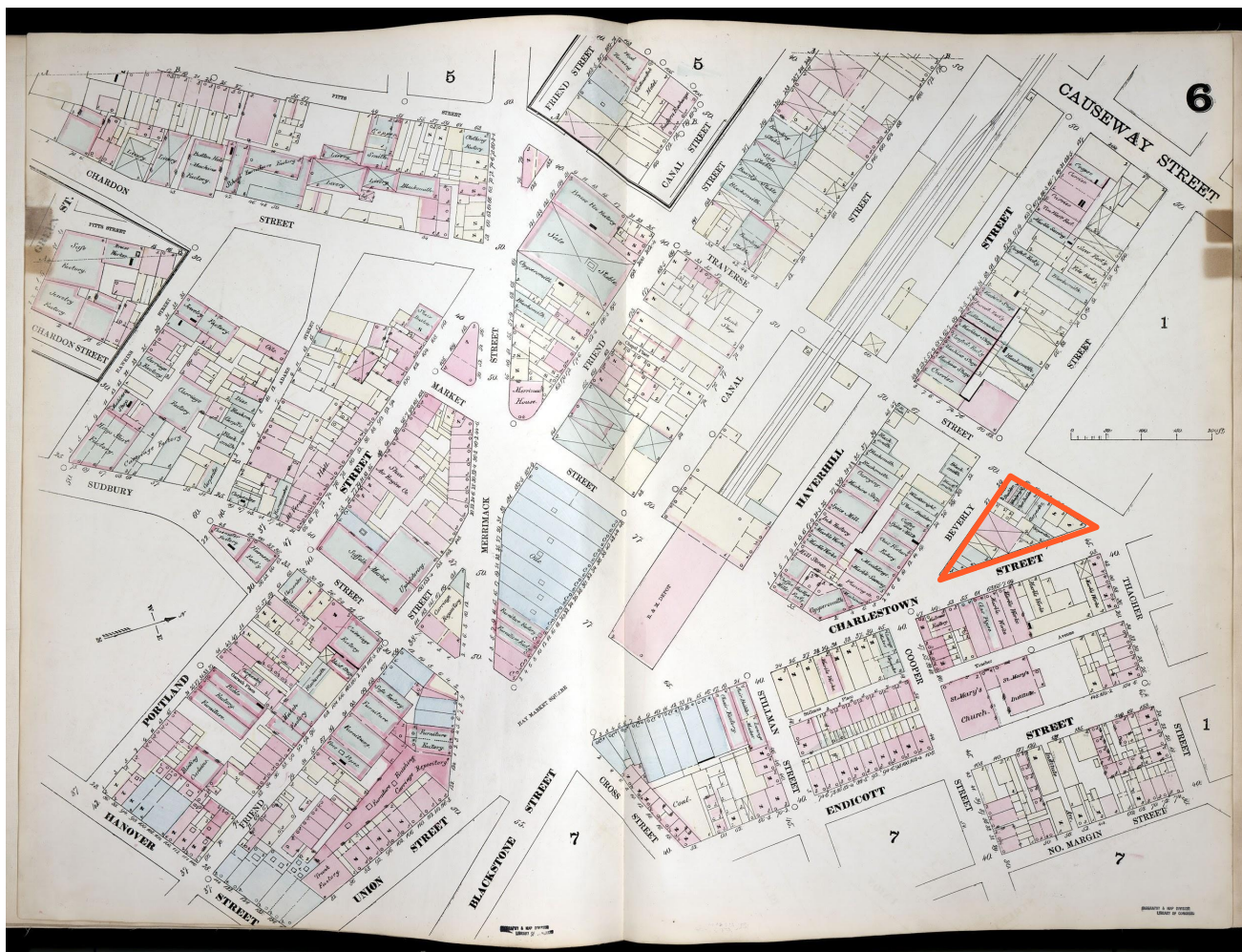

Sanborn Fire Insurance Map, 1867.



massDOT  
Massachusetts Department of Transportation

THE GREEN WAY  
Rose Kennedy Greenway.org

1980s



2013



Downtown Boston in 2013.

# 2018/2019

- **Initial BPDA Board Approval**  
June 2018
- **Request for Proposals Released**  
May 2019
- **Designer Selection**  
July 2019
- **Community Process Begins**  
August 14, 2019
- **Temporary Site Clean-up  
& New Fencing**  
Begins August 14, 2019

Complete





**boston planning &  
development agency**

# *Summary Site Analysis*

---

# Parcel 2 Traffic



— Surface Traffic

— Tunnel Traffic

..... Major Pedestrian Route

..... Pedestrian Route



# Construction Constraints & Considerations

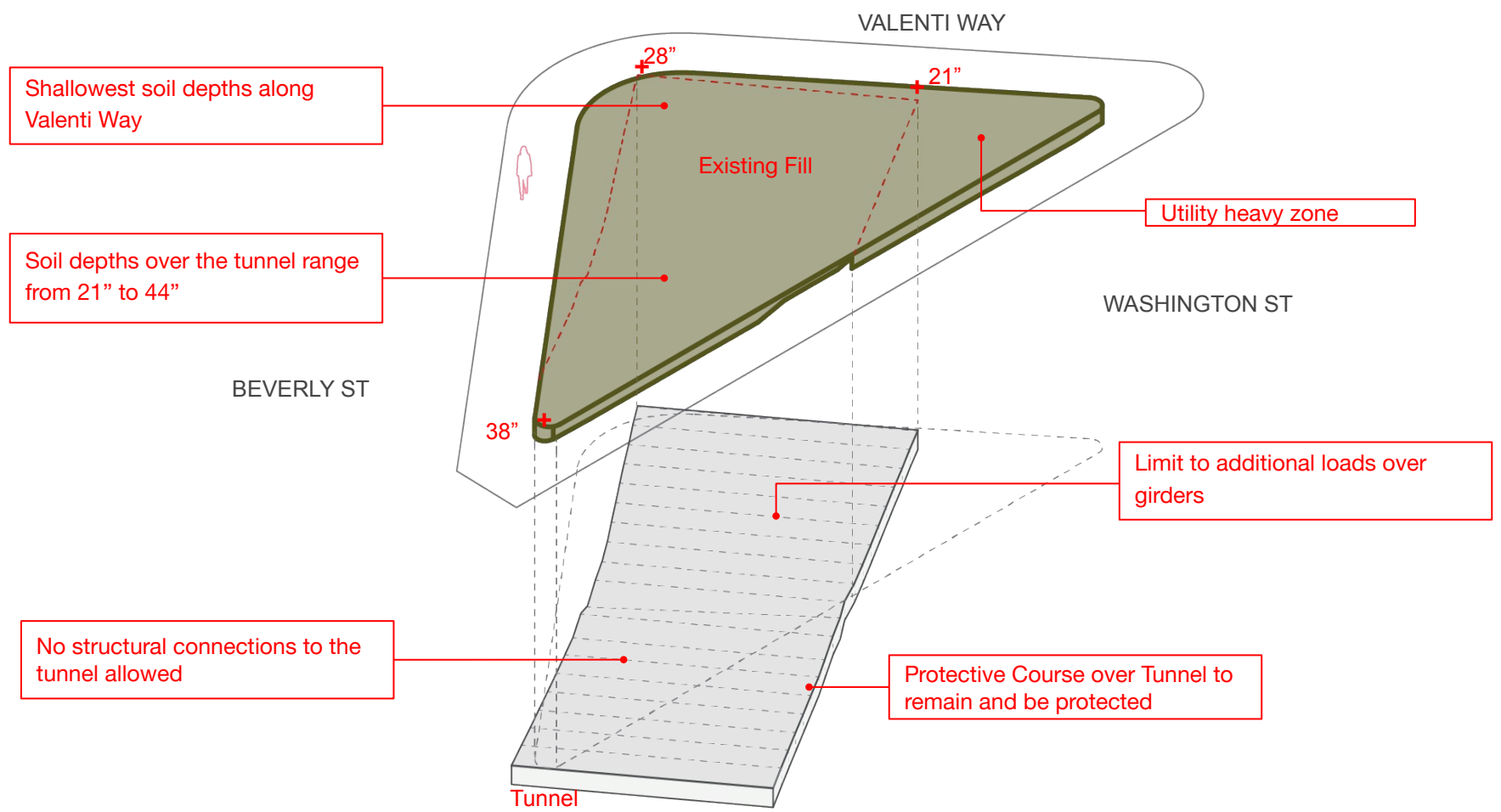



# Site Scale References

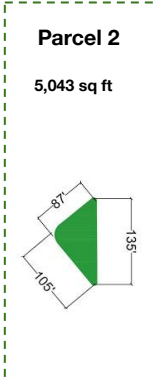

**Portal Park**  
15,500 sq ft

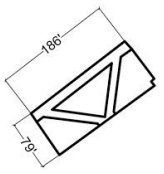

**Central Wharf Plaza**  
13,675 sq ft

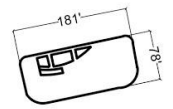

52,290 sq ft  
(ellipse)

**Hatch Memorial Shell**  
14,870 sq ft  
(shell)

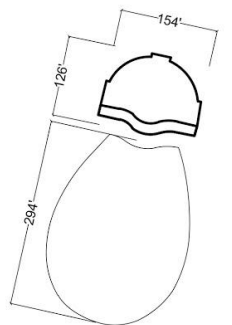

**ICA Deck**  
22,270 sq ft

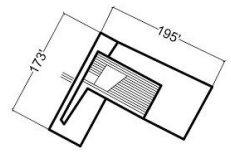

**Rings Fountain**  
38,700 sq ft

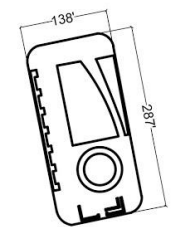

**Post Office Square**  
73,760 sq ft  
5,760 sq ft  
(triangle)

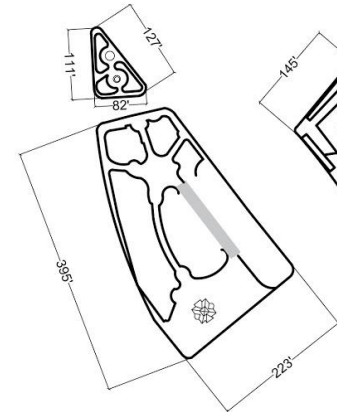

**Boston Harbor Pavilion**  
62,650 sq ft

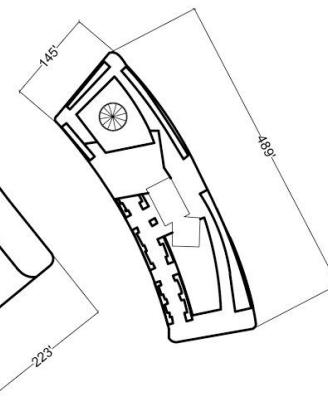

Source: ASK+

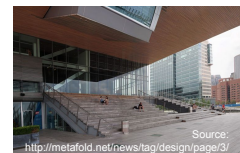
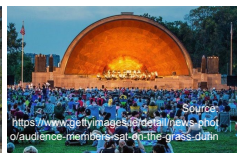
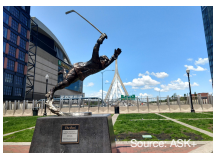

# Connecting East and West

Bulfinch Triangle

The North End

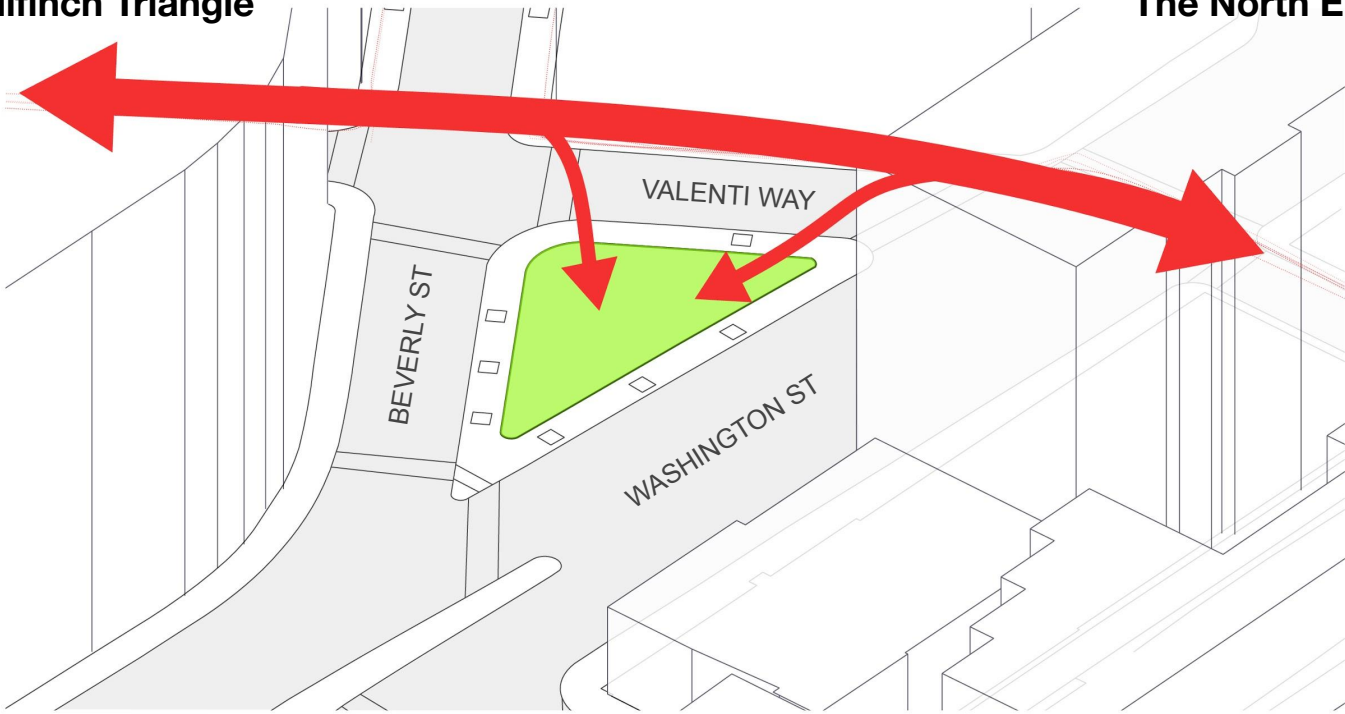

# Connecting to the Greenway



Parcel 2

Greenway

- ..... Route through 'not-the-Green way' landscape
- Road Crossings

# North / South Connection Viewsheds

Zakim Bridge

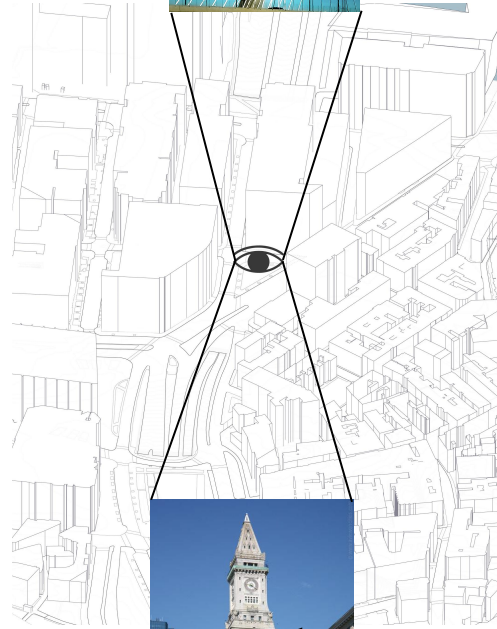
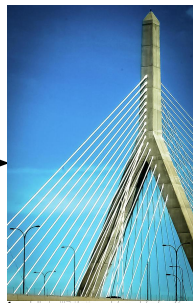

Custom House Tower

# Connecting to the Greenway



Source: Meg Baldwin

signage



Sources: Meg Baldwin

site furnishings

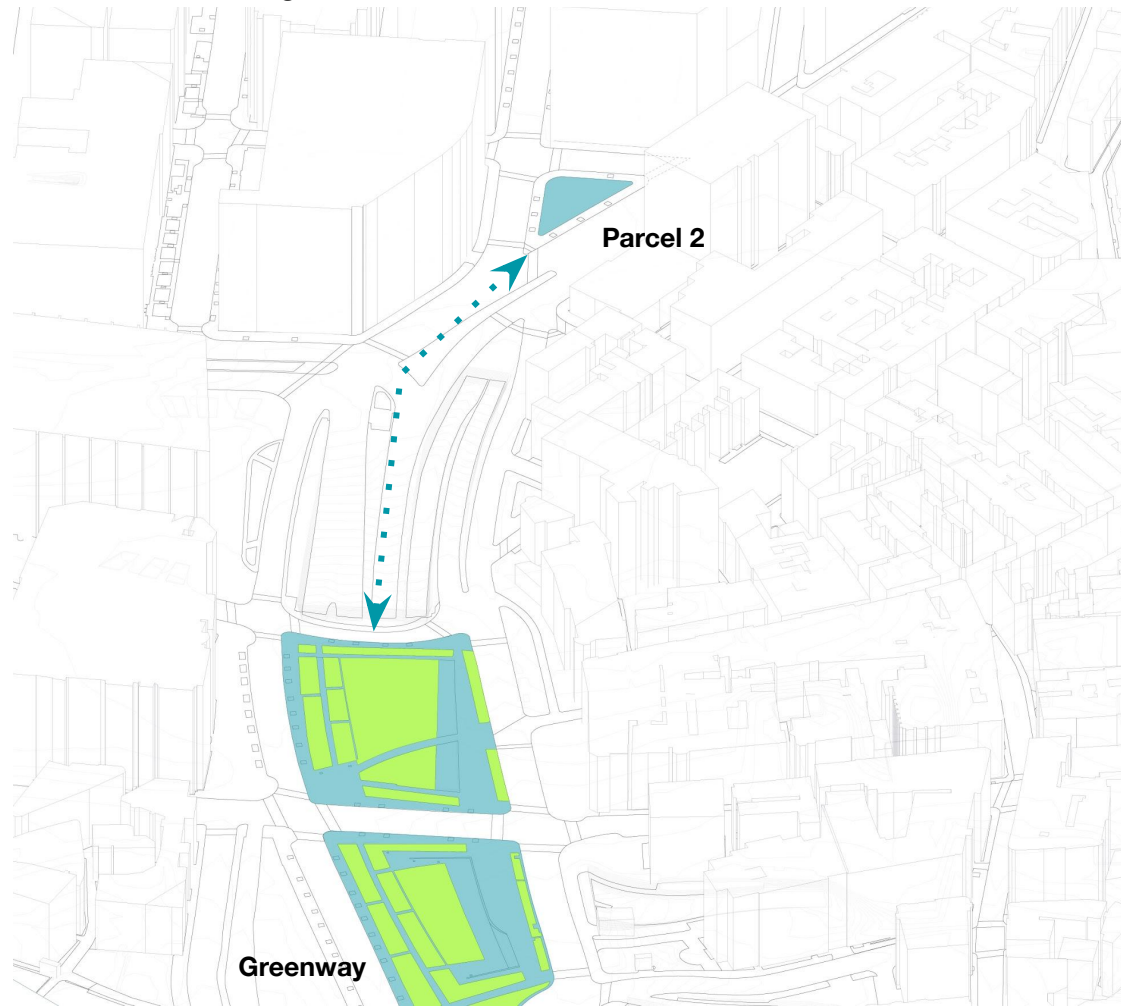

Source: Meg Baldwin

materials



Source: Meg Baldwin

plantings



Source: Meg Baldwin

Historical context

# Bring the Scale to the Person



Source: Sara Cohen

# Strong Edges and a Flexible Space





**boston planning &  
development agency**

*Project Team / Schedule*

*Public Process to Date: Site History & Analysis*

***Design Workshop Feedback***

*Concept Design Options*

---





# Design Workshop: Seeking Priorities / Requesting Vetoes

Please hand this in to one of the hosts when you have completed it. Instructions on back ->

WHAT DID WE FORGET?	WHEN?	WITH WHOM?	ACTIVITY	NATURE
	<p>Veto</p> <p>COMMUTE</p>	<p>Choice 3</p> <p>WEEKEND</p>	<p>Choice 2</p> <p>LUNCHTIME</p>	<p>Choice 1</p> <p>EARLY MORNING</p>
	<p>ALONE</p>	<p>FRIEND OR PARTNER</p>	<p>FRIENDS / GROUP</p>	<p>FAMILY</p>
	<p>POP-UP VENDING</p>	<p>TEMPORARY ART</p>	<p>HISTORY</p>	<p>FLEXIBLE TABLES &amp; CHAIRS</p>
	<p>NEW ENGLAND FOREST</p>	<p>NEW ENGLAND GEOLOGY</p>	<p>NEW ENGLAND COAST</p>	<p>BOG</p>
Choice 3 Veto 1	Choice 3	Choice 2	Choice 1	

Choice 3 Veto 1	Choice 1	Choice 2	Choice 3	VETO
<p>NEW ENGLAND FOREST</p>	<p>MEADOW</p>	<p>NEW ENGLAND COAST</p>	<p>WILD CARD</p>	<p>WILD CARD</p>
<p>MOMENTS OF SOLITUDE</p>	<p>POP-UP VENDING</p>	<p>TEMPORARY ART</p>	<p>MOMENTS OF SOLITUDE</p>	<p>WILD CARD</p> <p>WILD CARD</p>
<p>CHILDREN/PETS</p>	<p>ALONE</p>	<p>WORK COLLEAGUES</p>	<p>WILD CARD</p>	<p>WILD CARD</p>
<p>LUNCHTIME</p>	<p>WEEKEND</p>	<p>COMMUTE</p>	<p>GAMETIME</p>	<p>WILD CARD</p>
WHAT DID WE FORGET?				

Choice 3 Veto 1	Choice 1	Choice 2	Choice 3	VETO
<p>MEADOW</p>	<p>NEW ENGLAND GEOLOGY</p>	<p>WILD CARD</p>	<p>WILD CARD</p>	<p>WILD CARD</p>
<p>POP-UP VENDING</p>	<p>TEMPORARY ART</p>	<p>MOMENTS OF SOLITUDE</p>	<p>FLEXIBLE TABLES &amp; CHAIRS</p>	<p>WILD CARD</p>
<p>CHILDREN/PETS</p>	<p>FRIEND OR PARTNER</p>	<p>ALONE</p>	<p>WILD CARD</p>	<p>WILD CARD</p>
<p>LUNCHTIME</p>	<p>EVENING TIME</p>	<p>EARLY MORNING</p>	<p>WILD CARD</p>	<p>WILD CARD</p>
WHAT DID WE FORGET?				

Choice 3 Veto 1	Choice 1	Choice 2	Choice 3	VETO
<p>MEADOW</p>	<p>GROVE</p>	<p>NEW ENGLAND FOREST</p>	<p>BOG</p>	<p>WILD CARD</p>
<p>TEMPORARY ART</p>	<p>MOMENTS OF SOLITUDE</p>	<p>HISTORY</p>	<p>POP-UP VENDING</p>	<p>WILD CARD</p>
<p>CHILDREN/PETS</p>	<p>ALONE</p>	<p>FRIEND OR PARTNER</p>	<p>WILD CARD</p>	<p>WILD CARD</p>
<p>WEEKEND</p>	<p>LUNCHTIME</p>	<p>EVENING TIME</p>	<p>EARLY MORNING</p>	<p>WILD CARD</p>
WHAT DID WE FORGET?				

# Seeking Priorities / Requesting Vetoes

## Aila's Plan for the Park

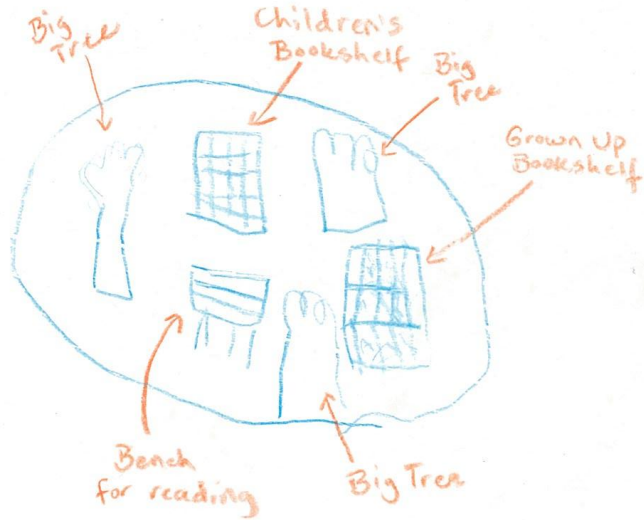

First Choice: 3 points

Second Choice: 2 points

Third Choice: 1 point

Vetoes: 1 point

All comments recorded.

# Character | SEARCHING FOR A FEELING

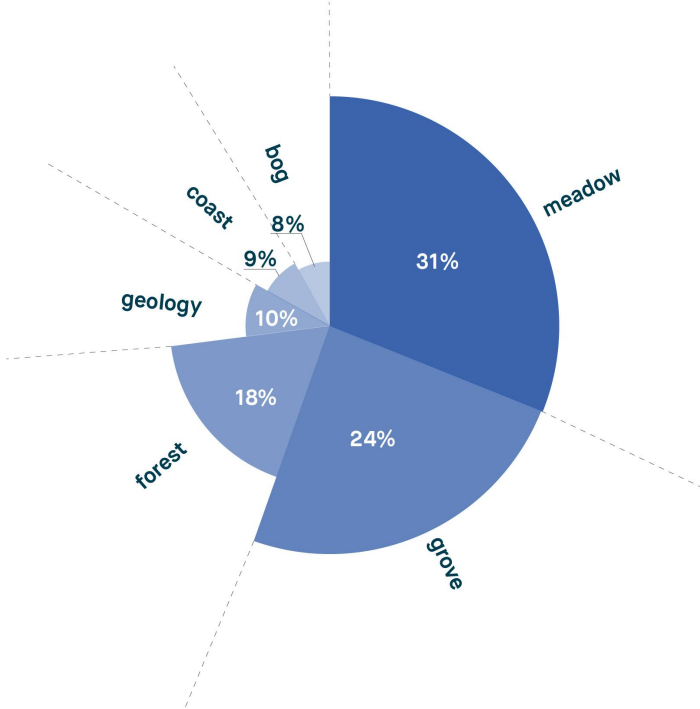

MEADOW

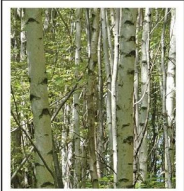

GROVE



NEW ENGLAND FOREST

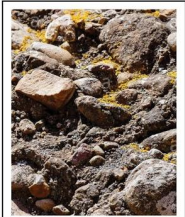

NEW ENGLAND GEOLOGY

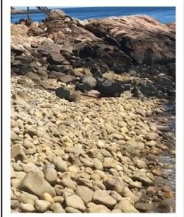

NEW ENGLAND COAST

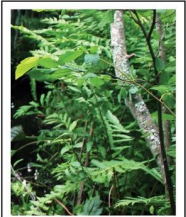

BOG

# With Whom? | WHO DO YOU IMAGINE VISITING THE SITE WITH?

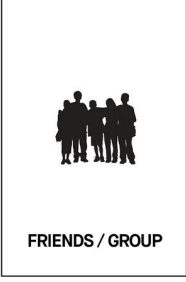
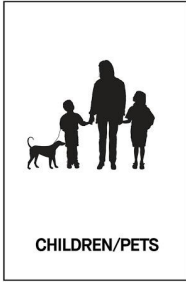
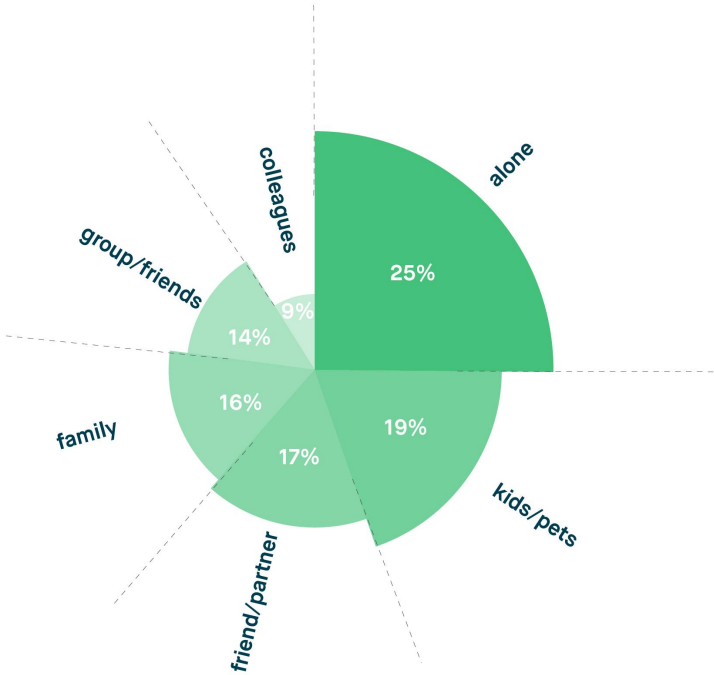

# Activity | WHAT WOULD YOU LIKE TO DO AT PARCEL 2?

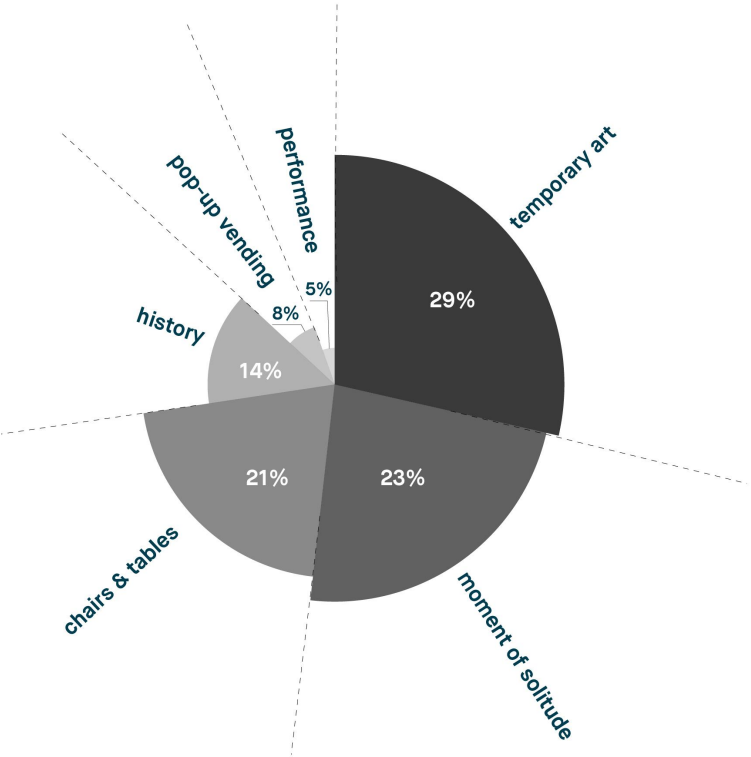

TEMPORARY ART

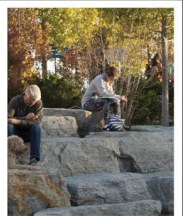

MOMENTS OF SOLITUDE



FLEXIBLE TABLES & CHAIRS

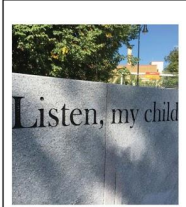

HISTORY



POP-UP VENDING



PERFORMANCE/EXHIBITION

# When? | WHAT TIME OF DAY, OR YEAR, WILL YOU VISIT?

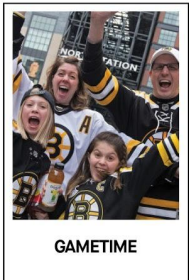
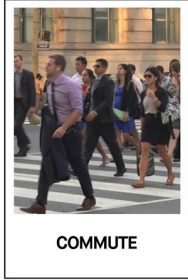
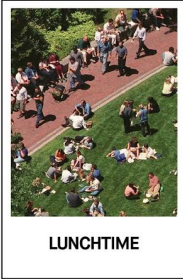
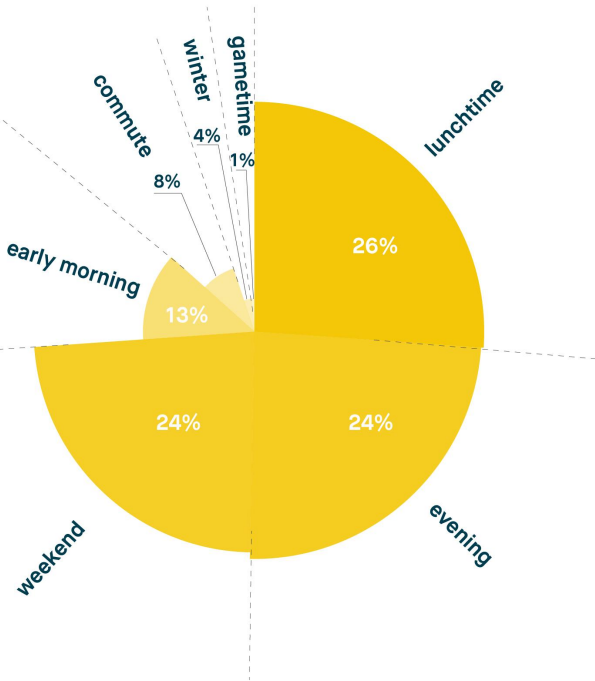



**boston planning &  
development agency**

*Project Team / Schedule*

*Public Process to Date: Site History & Analysis*

*Design Workshop Feedback*

***Concept Design Options***

---





**boston planning &  
development agency**

## ***Concept 1: Meadow***

***This Was Once A Pond***

---

# History

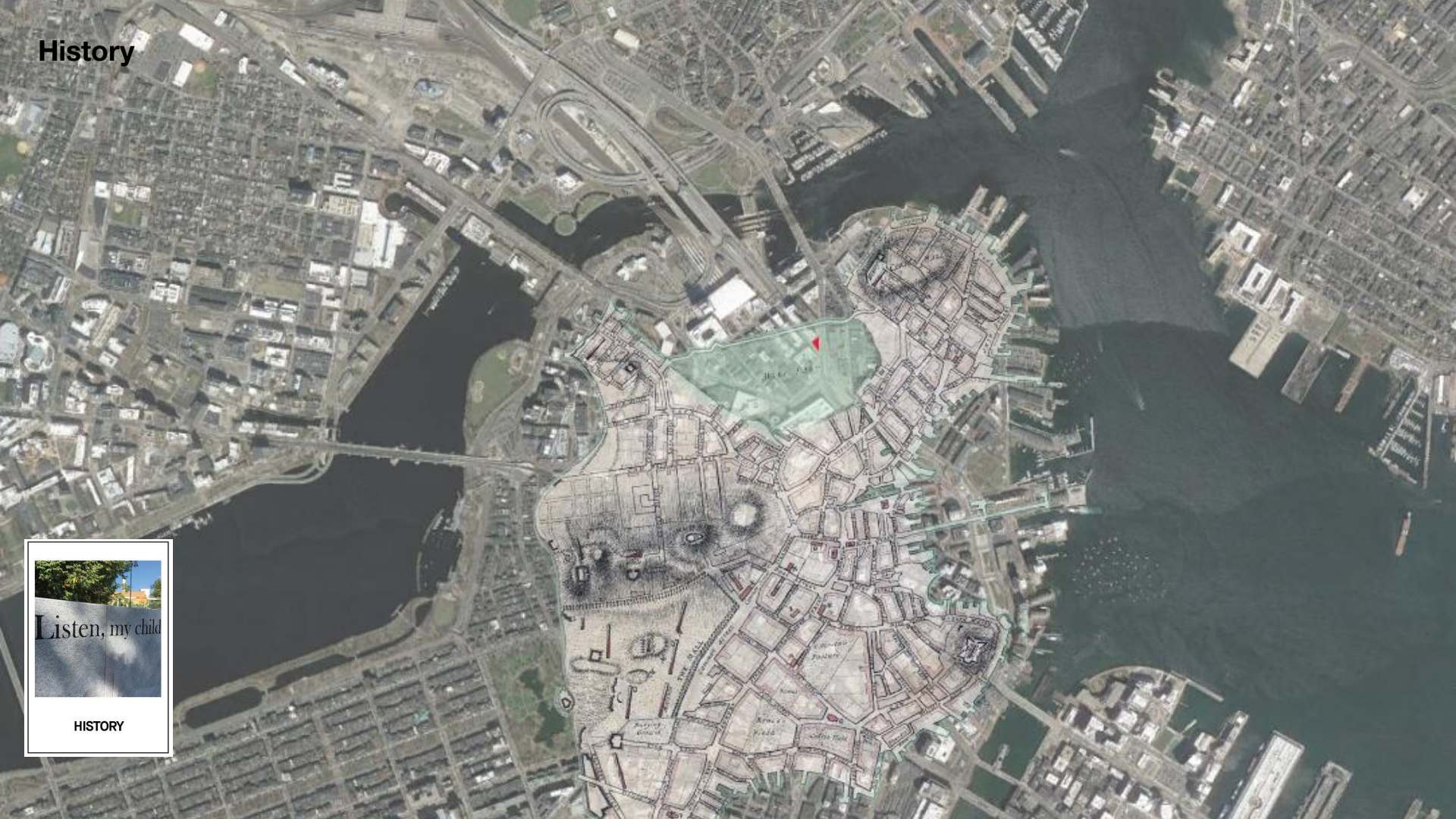

# Precedent



# Meadow

## This was once a Pond



HISTORY



MEADOW



LUNCHTIME



EVENING TIME



WEEKEND



MOMENTS OF SOLITUDE



FLEXIBLE TABLES & CHAIRS



ALONE



CHILDREN/PETS



FRIEND OR PARTNER

# Meadow

## This was once a Pond

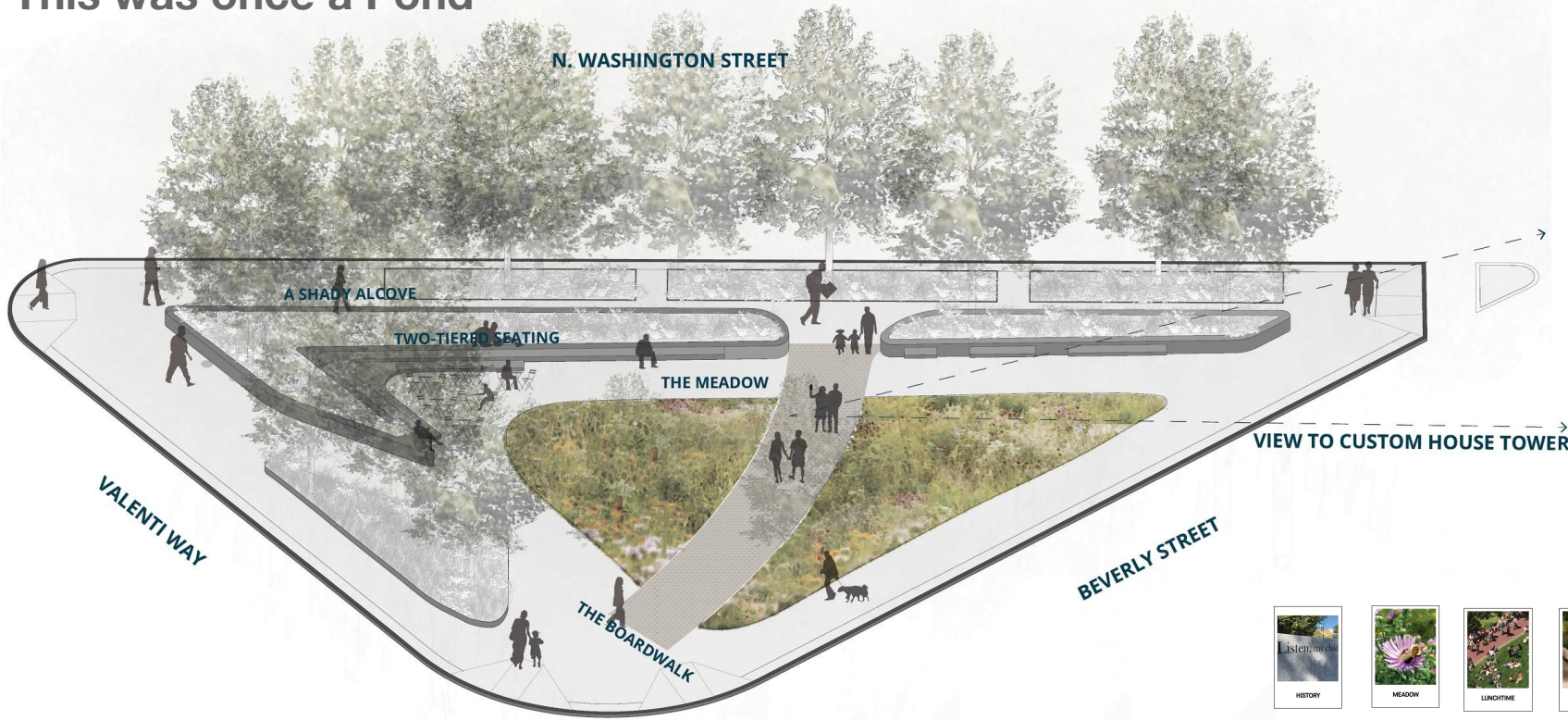

# Material Approach



Source: [www.flickr.com/photos/rusmurray/8526651430/](http://www.flickr.com/photos/rusmurray/8526651430/)



**Greenway Meadow**

Source: Rose Kennedy Greenway



**Mother's Walk**

Source: ASK



Source: West 8

**Floating Path Options**



Source: Rose Kennedy Greenway

**Native Meadow**



Source: [www.urbaneer.com/blog/village\\_of\\_yorkville\\_park\\_toronto](http://www.urbaneer.com/blog/village_of_yorkville_park_toronto)

**Retaining & Enclosing Edge**



**boston planning &  
development agency**

## ***Concept 2: The Tiered Grove***

---

# Singular Grove

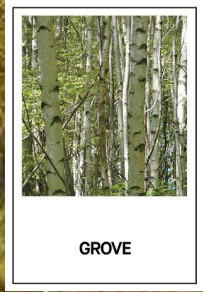



# New England Geology

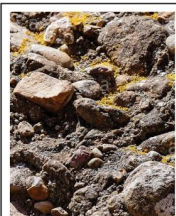

NEW ENGLAND GEOLOGY

# Urban



WORK COLLEAGUES



FRIENDS / GROUP



FAMILY



# The Tiered Grove



# The Tiered Grove

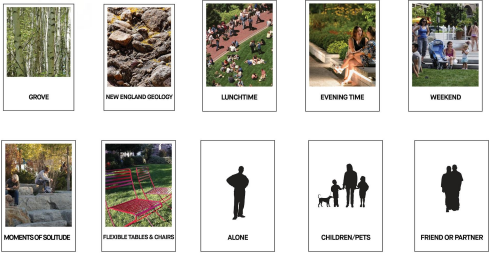

# Material Approach



Source: South Cove, New York, [tcf.org/susan-cl-nd](http://tcf.org/susan-cl-nd)



Source: Novartis, [www.vogt-la.com/en/project/novartis-campus-park-basel](http://www.vogt-la.com/en/project/novartis-campus-park-basel)



Source: York Quay, Toronto, [www.mvva-inc.com](http://www.mvva-inc.com)



Source: Jane Messinger

## Filtering Grove



Source: Ohio State University, Columbus, OH, [www.mvva-inc.com](http://www.mvva-inc.com)

## Social Seating

## Signature Walls & Paving



**boston planning &  
development agency**

## ***Concept 3: The Winter Garden***

---

# Resilient Seasonal Planting



NEW ENGLAND FOREST

# Winter in Boston



WINTERTIME

Source: Nicolaus Czarnecki, Boston Herald



Winter

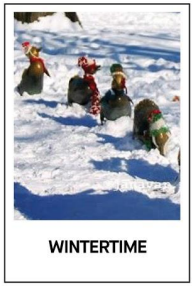

# Winter

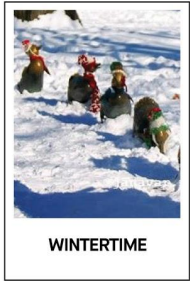

WINTERTIME

# The Winter Garden



MEADOW



NEW ENGLAND COAST



LUNCHTIME



EVENING TIME



WINTERTIME



MOMENTS OF SOLITUDE



FLEXIBLE TABLES & CHAIRS



ALONE



CHILDREN/PETS



FRIEND OR PARTNER

# The Winter Garden

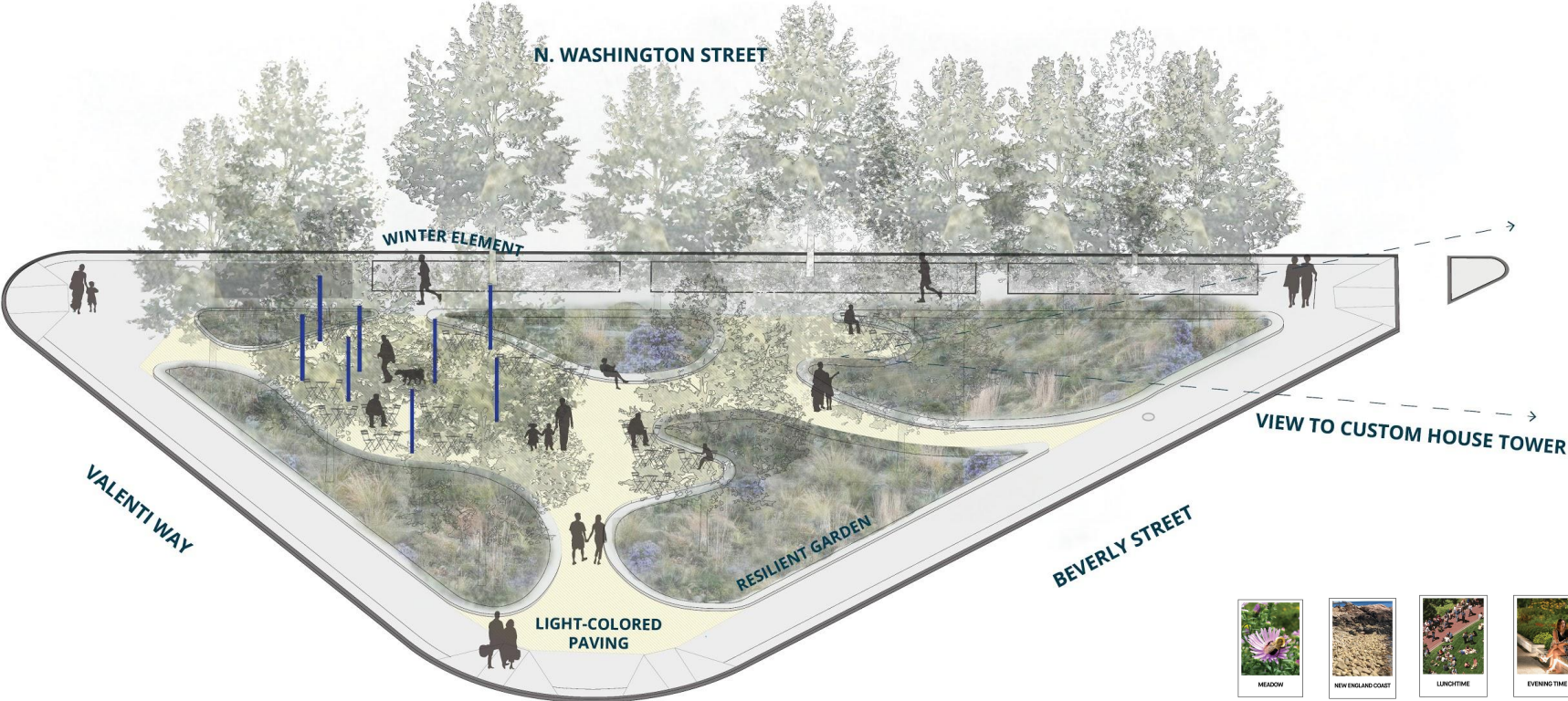

# Material Approach



**Loose Furnishings**



**Warm-toned Unit Pavers**



**Resilient Garden**



**Winter Light Element**

# 3 Concepts for Parcel 2

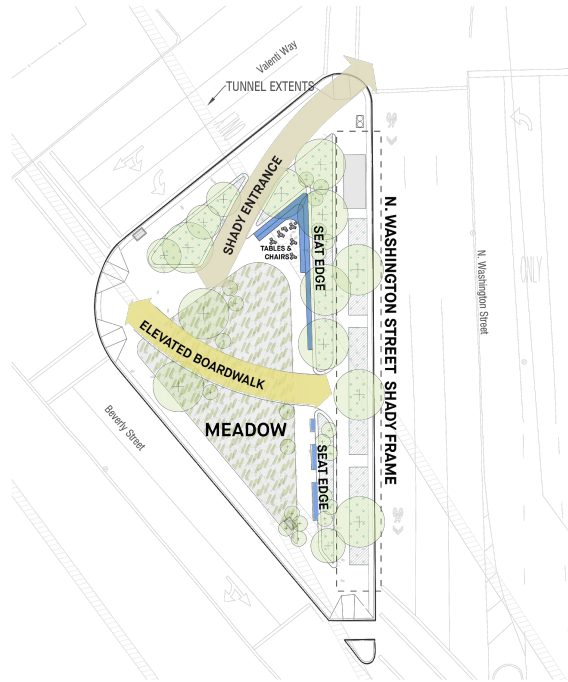

Meadow



Grove



Garden



**boston planning &  
development agency**

***Want to provide more feedback?***

***There will be 2 more Public Meetings!***

***Meeting 4: Preferred Design Presentation***

***Meeting 5: Design Update***

***For more information, visit: <http://bit.ly/greenwayp2>***

---