

Summer & Congress Streets

Urban Design and Engineering Services Relative to the Reconstruction of Congress and Summer Streets in the City of Boston



Children's Museum



Congress St. Bridge



FP3



Summer + Congress = Ft. Pt. District

- Congress Street
 - Treatment of building entrances
 - Opportunity for design of open spaces at back of sidewalk
 - Green fence edge treatments
 - Opportunity for light towers at green fence edge
 - Custom street imprint pattern at crosswalks
 - Raised crosswalks at driveways
 - Shared vehicular travel lane / bike route
- Summer Street
 - Street tree plantings and use of storm water for irrigation
 - Linear special pavement strip for site furnishings and interpretive elements
 - Opportunity for LED screens for changing exhibits / displays
 - Benches at street edge
 - Lighting with opportunity for cross street or hanging banners/lights
 - Designated bike lanes
 - Custom street imprint pattern at crosswalks
- Common Elements
 - Crosswalks with light strip
 - Crosswalk street imprint
 - Trash + Parking Meter
 - Newspaper Corrals
 - Bike Racks
 - Building Lighting
 - Bridge Lighting



Congress St. Improvements

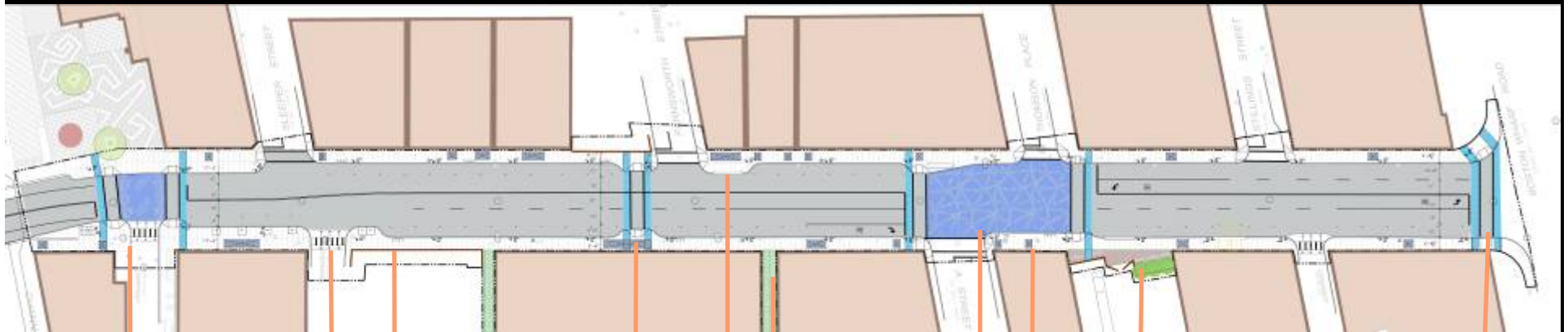

Green Fence at parking lots

Raised crossings at driveways

Children's Museum Crossing: Wide sidewalks, short term parking, street imprint and lighted crossing, bike racks.

"Green Alleys"

Fire Museum Bump out

Bump outs to decrease crossing distance

Entrance Treatment "Placeholders"

A Street Intersection: Bump outs, widened sidewalk, street imprint, new signals, and lighted crosswalk

Transformer Site seating

Lighted crosswalk

Street Dimensions



Children's Museum

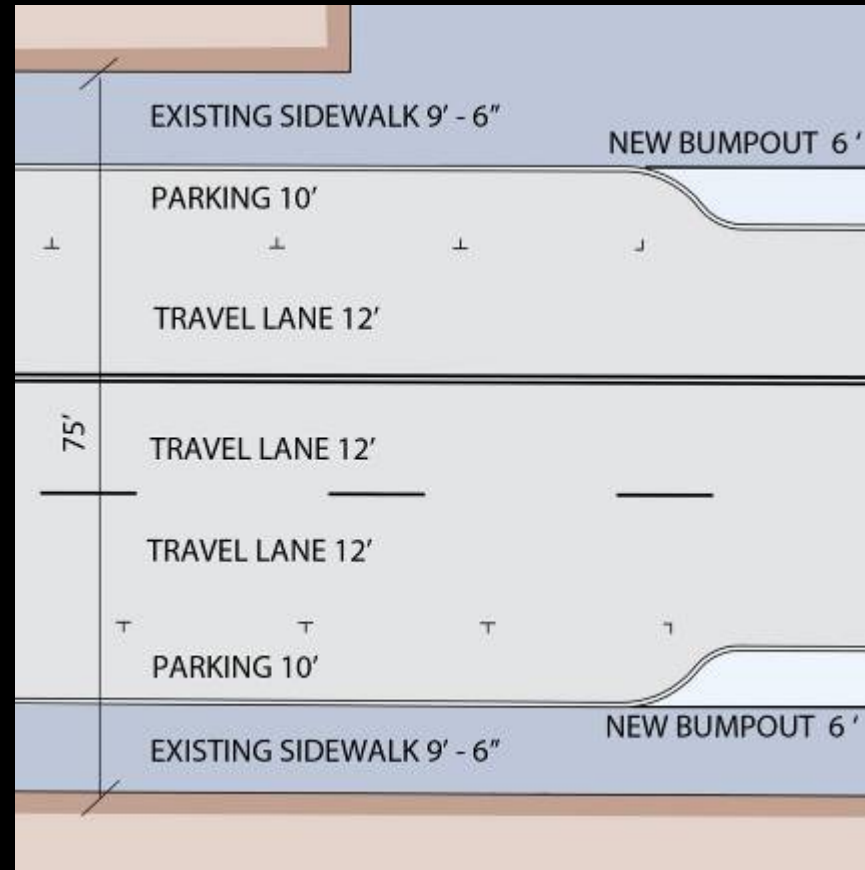

Typical

Bike Lane Diagram

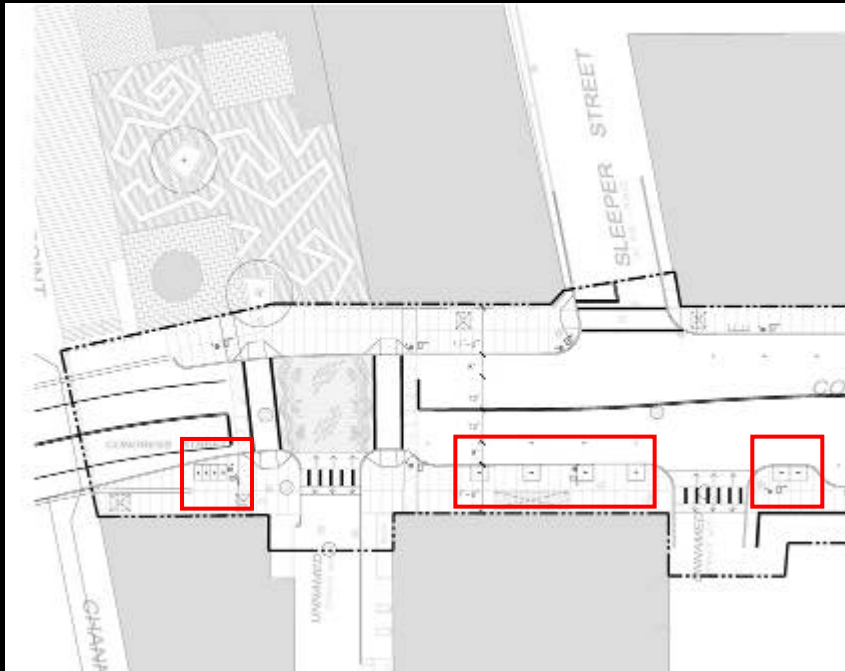

Green Fence



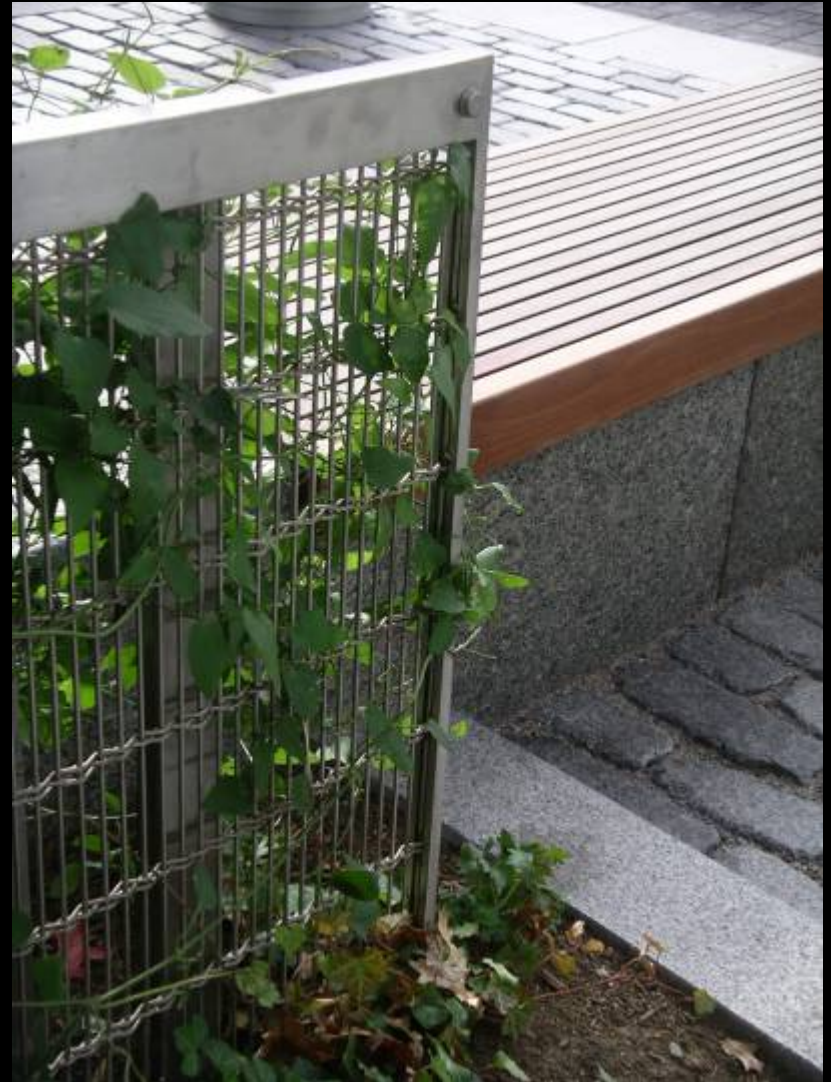

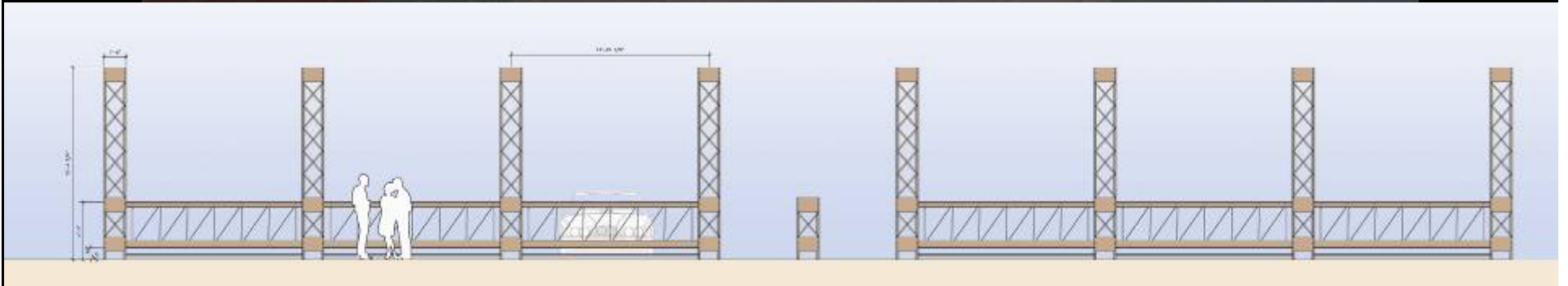





Lighting



EXISTING LIGHTING CONDITIONS-CONGRESS STREET



PROPOSED LIGHTING CONDITIONS-CONGRESS STREET

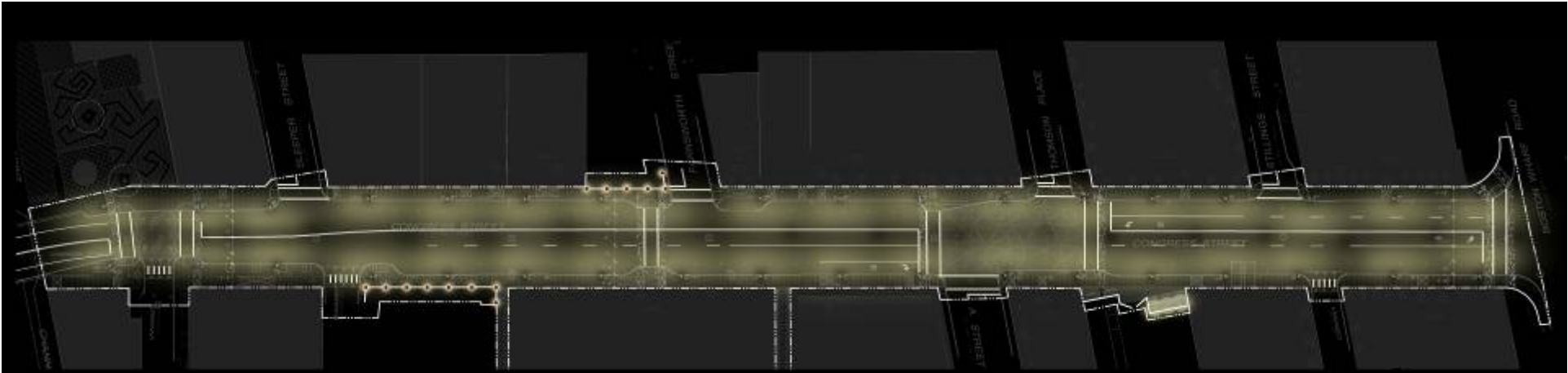

Building Lighting

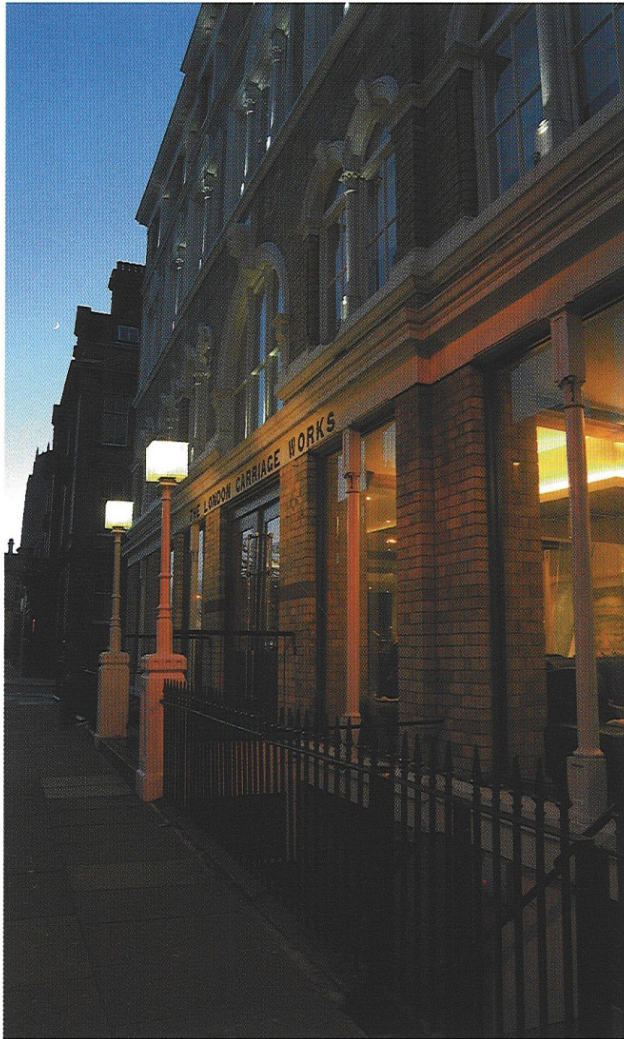

Hope Street Hotel.



Sidewalk Treatments





Summer St. Improvements

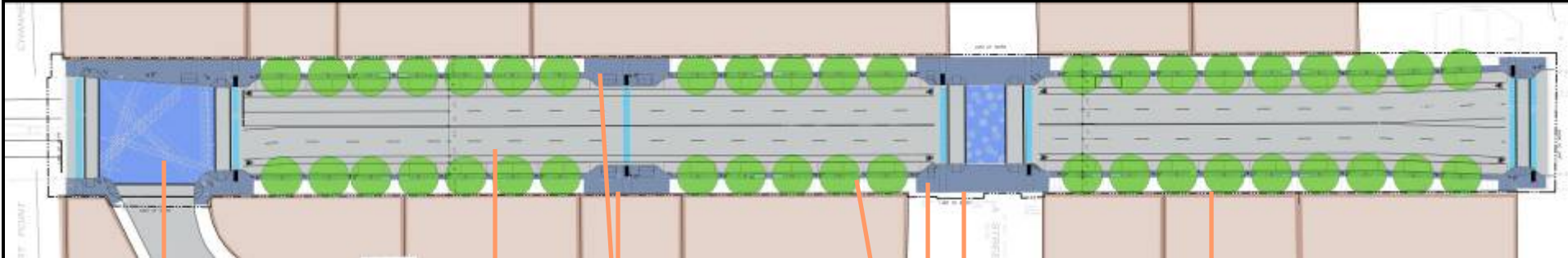

Crossings made shorter and highlighted with street imprint and lighting

Bumpouts for display screens or art

A Street Overpass crossing

Paired street trees with openings at crossings and for public art

New striping, lighting, bike racks, and signals throughout

Granite gathering areas and continuity strips with drainage detail

Street Dimensions



Typical



At Bump out

Bike Lane Diagram

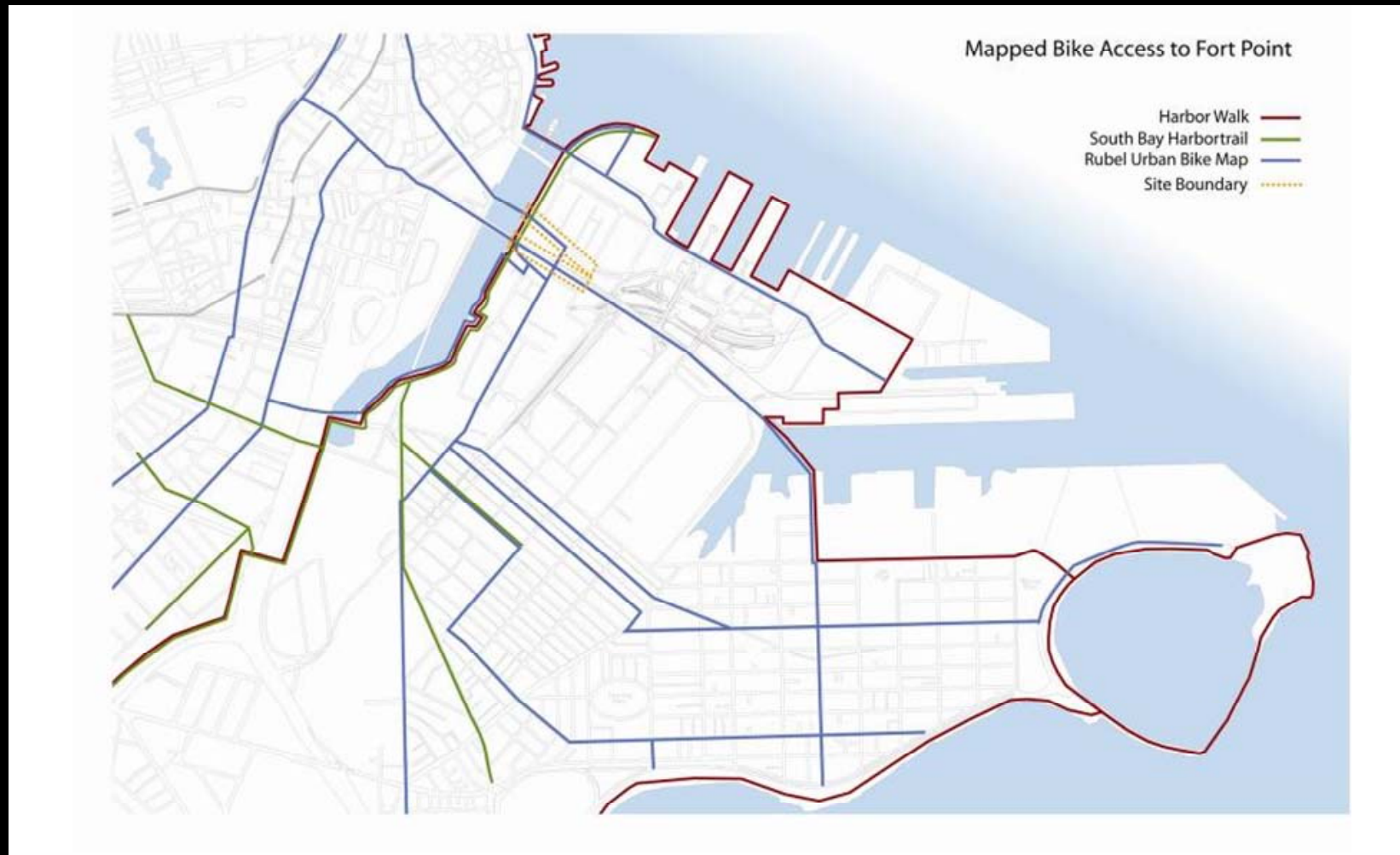

Bike Accommodation

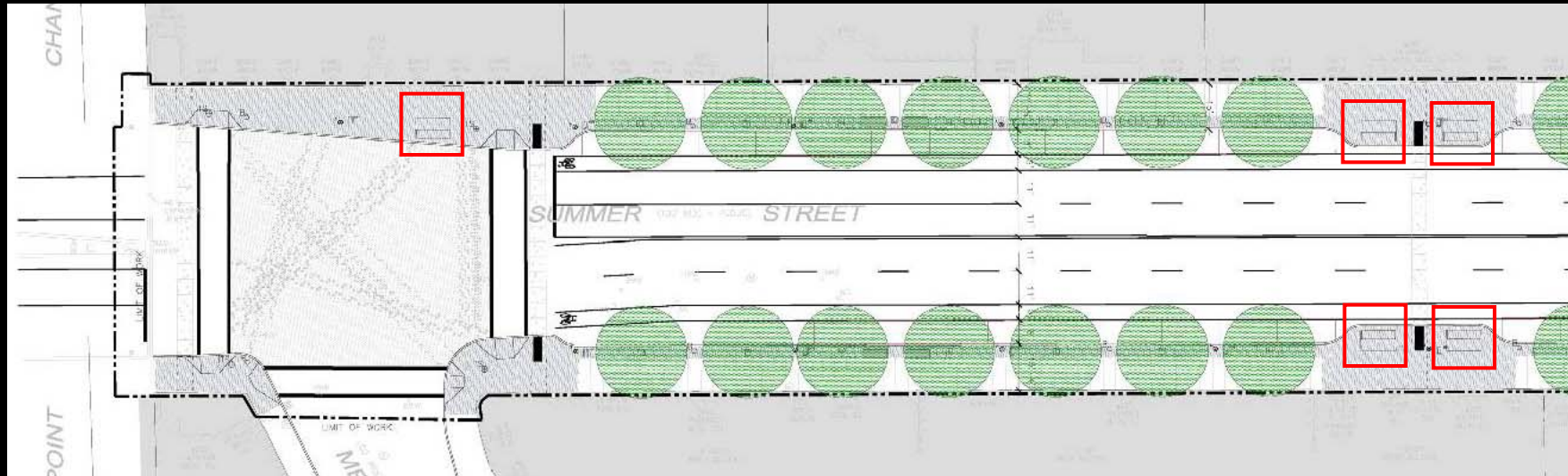

21. Northwest corner of Fourth & Muhammad Ali
Artist: David Bibelhauser
Medium: Stainless steel

Improvements



Drainage Detail and Street Furniture

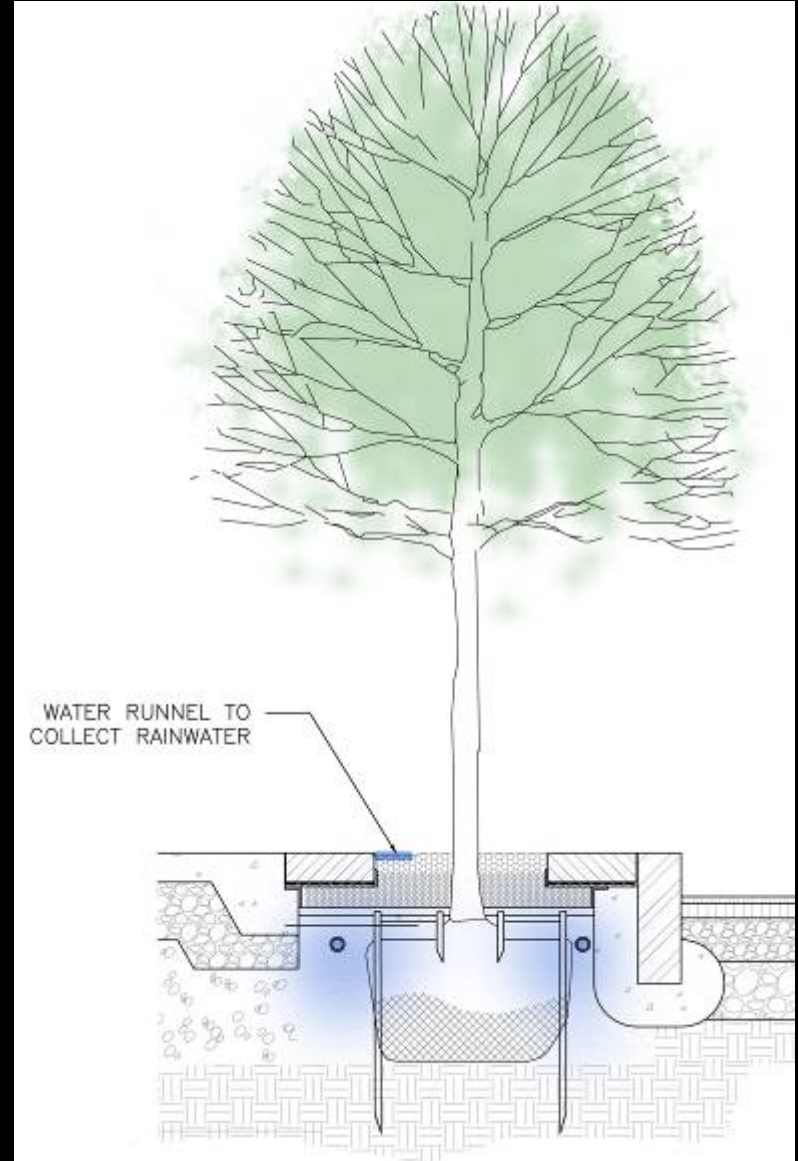
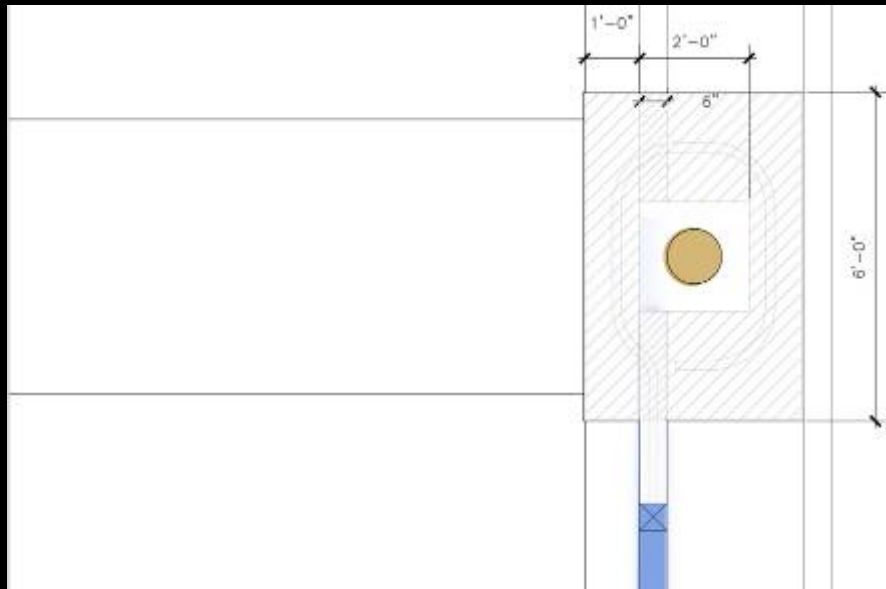

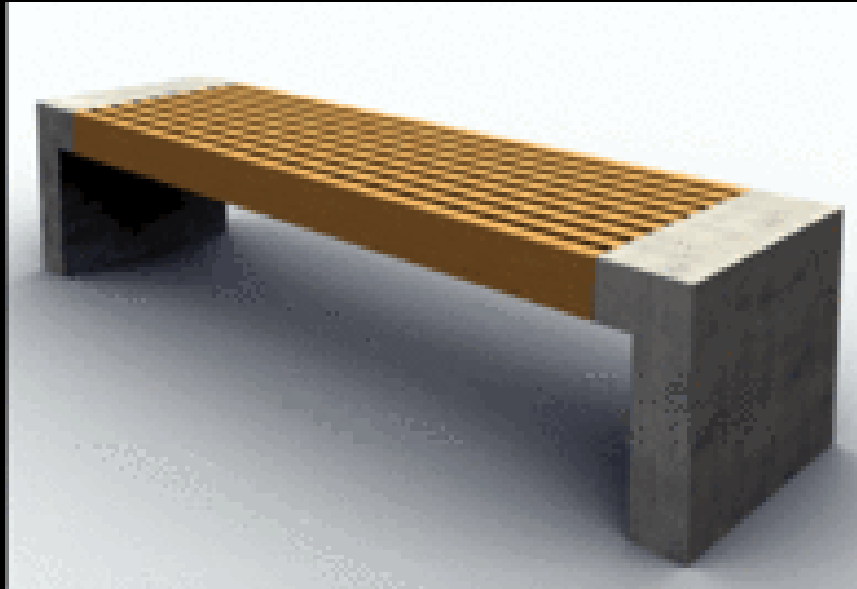



EXISTING LIGHTING CONDITIONS-SUMMER STREET



PROPOSED LIGHTING CONDITIONS-SUMMER STREET

Summer St. Lighting







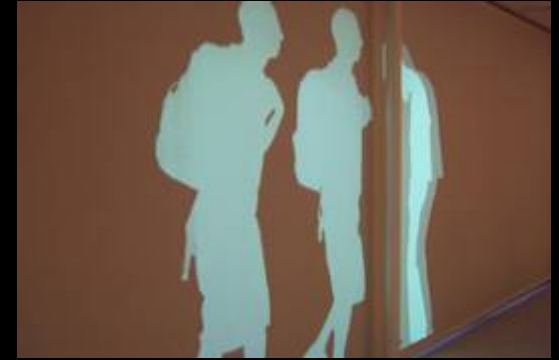

Common Elements



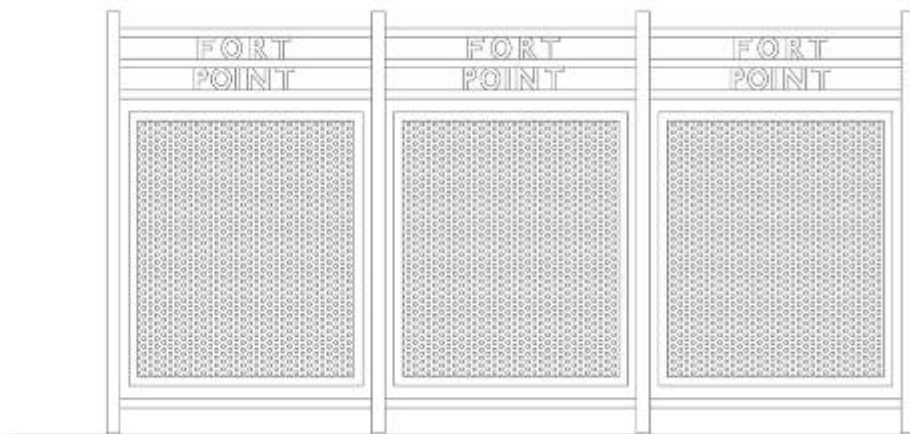
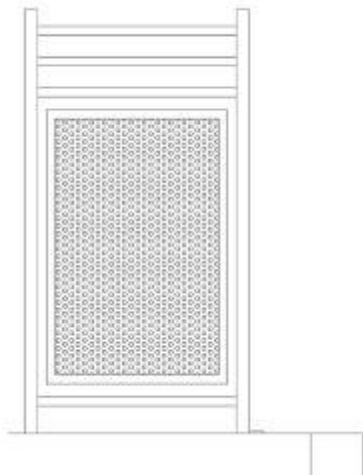

Street Imprint at Intersections - Actual Product



HISTORICAL USES PRE 1950

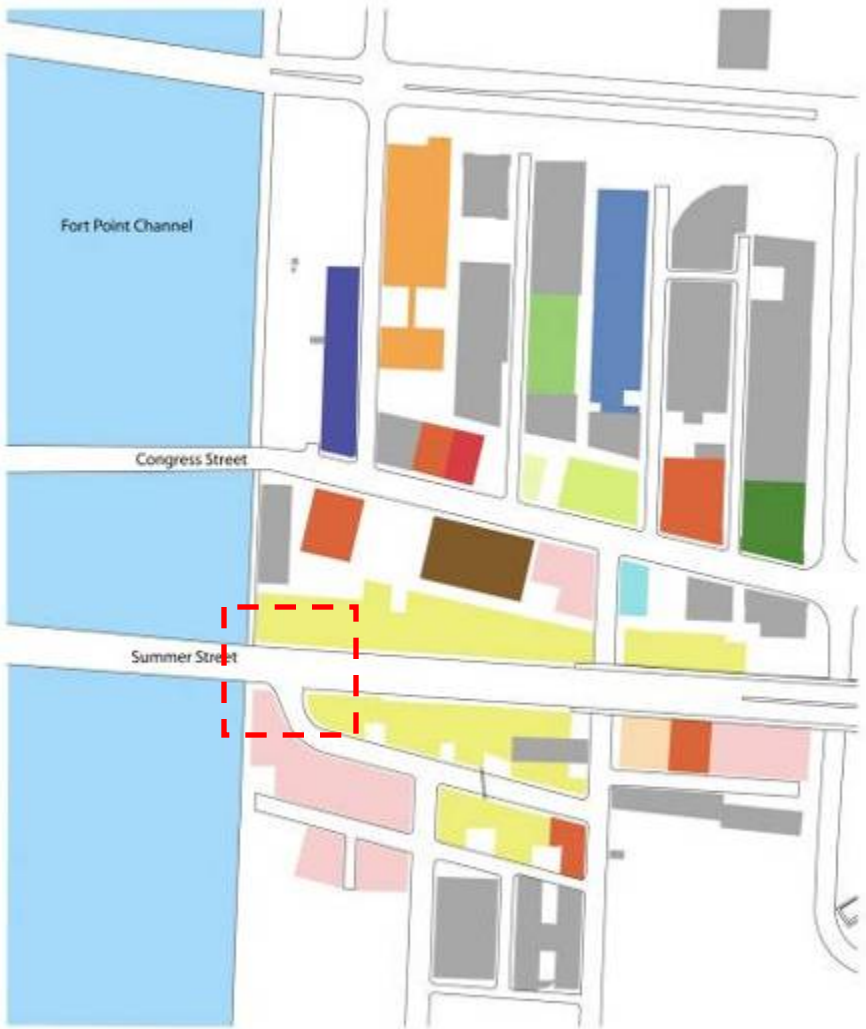

- | | | | |
|---|--|---|--------------------------------|
|  | Candy Makers |  | Glass Manufacturing |
|  | Wool Storage |  | Atlas Stores - General Storage |
|  | Fire House |  | Ink for Shoes - Manufacturing |
|  | Rags and Waste Paper Dealer |  | Leather Tannery/ Cobbler |
|  | Paint Factory |  | Mattress Factory |
|  | Baseball Stadium  |  | Spices and Coffee |
|  | Electrical and Lighting Machine Shop |  | Stables and Mechanic |

Possible Patterns

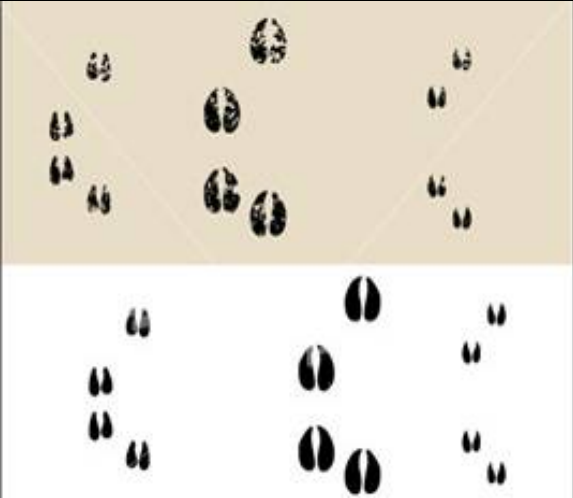
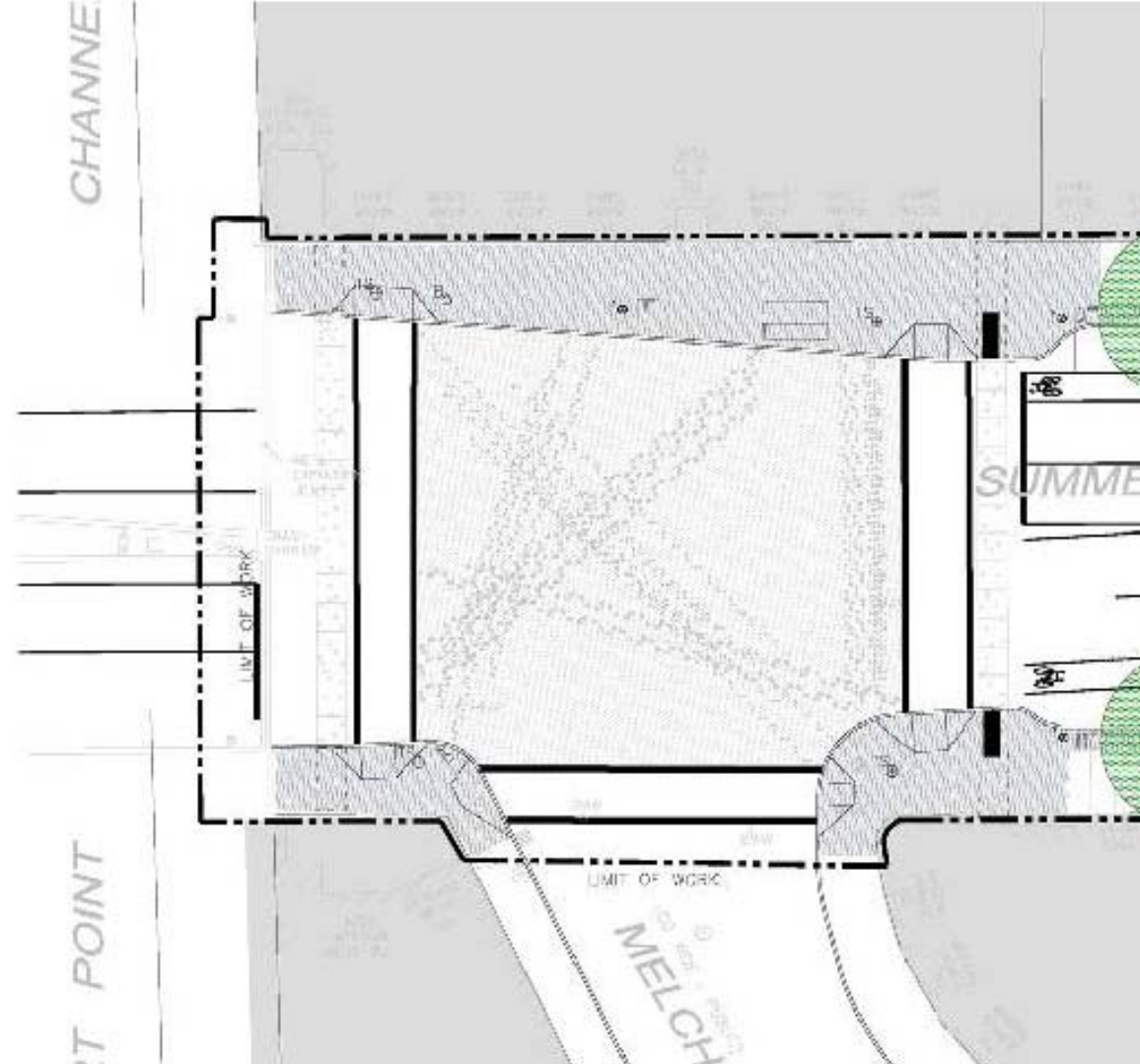

Possible Patterns

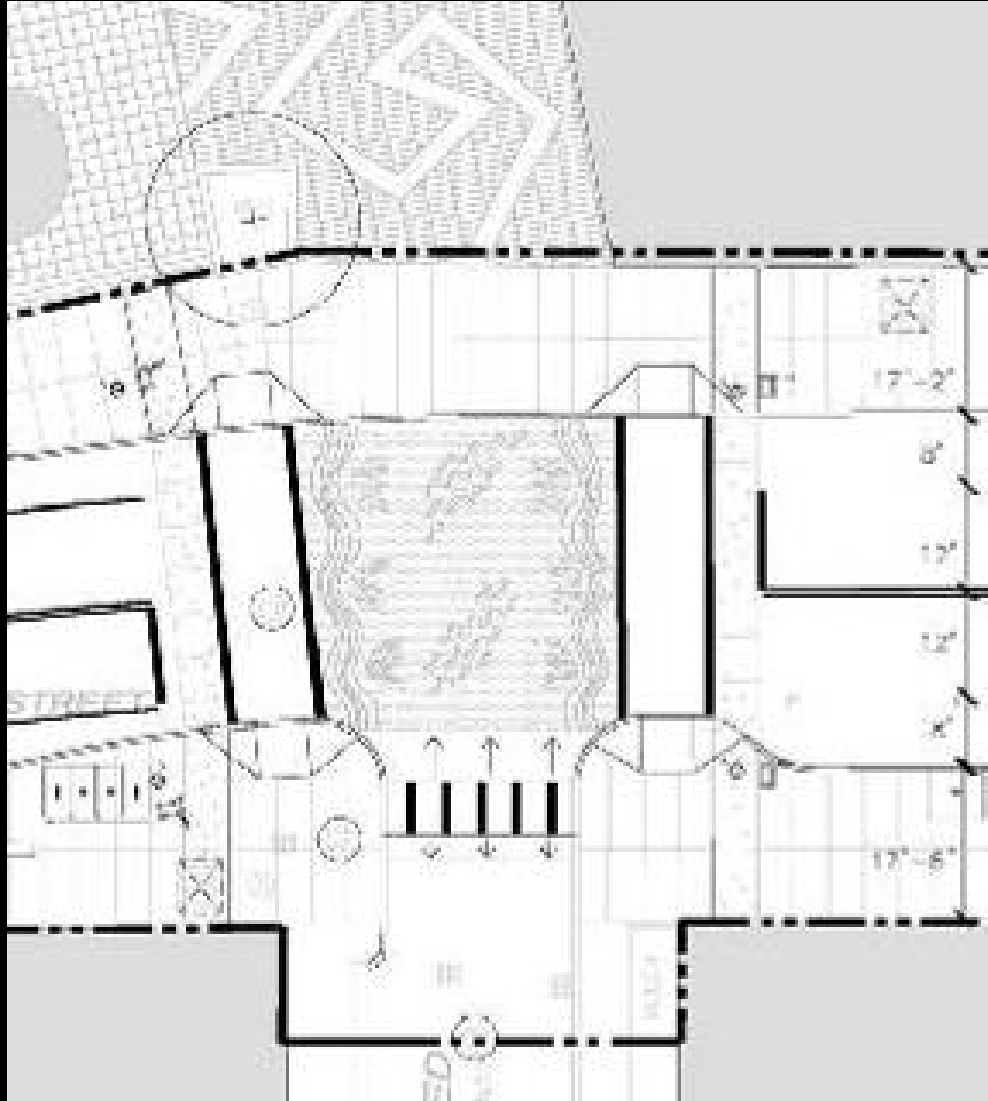

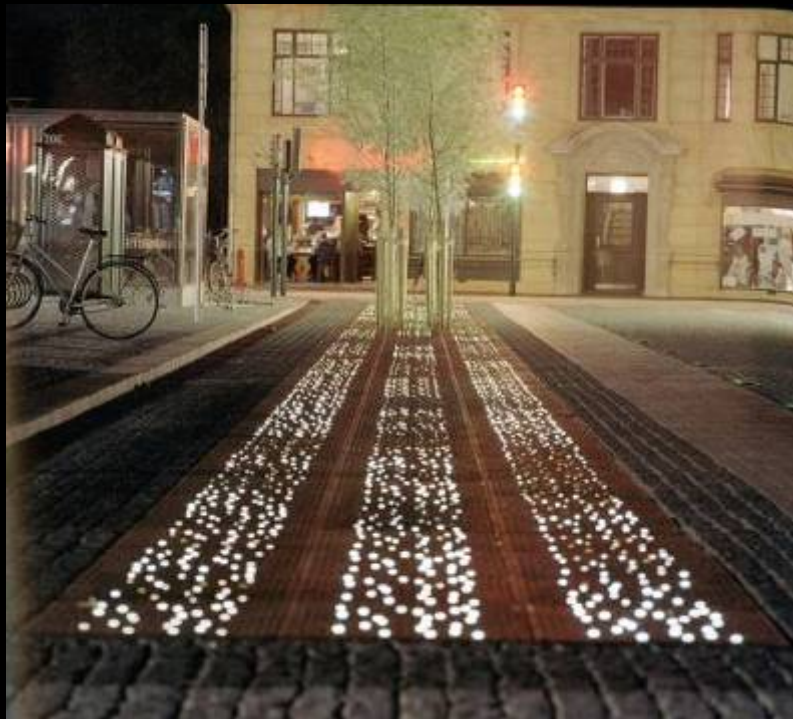

C|S|S











