

# Summer & Congress Streets

Community Update  
October 30th, 2013



Urban Design and Engineering Services Relative to the Reconstruction  
of Congress and Summer Streets in the City of Boston

# Projects

**Congress Street Sleeper to Boston Wharf**

**Congress Street Intersection**

**Summer Street**

Labels on map: FAN PIER COURTHOUSE, INSTITUTE OF CONTEMPORARY ART, COMMONWEALTH PIER, WORLD TRADE CENTER, NORTHERN AVENUE, ROSE KENNEDY GREENWAY, ATLANTIC AVENUE, SOUTH STATION, POST OFFICE, FORT PORTER, WORMWOOD PARK, BOSTON CONVENTION & EXHIBITION CENTER, D STREET, BOSTON WHARF ROAD, PROPOSED HARBOR STREET, WORLD TRADE CENTER AVENUE.

CONGRESS AND SUMMER STREETS

# Congress Street Intersection Plan

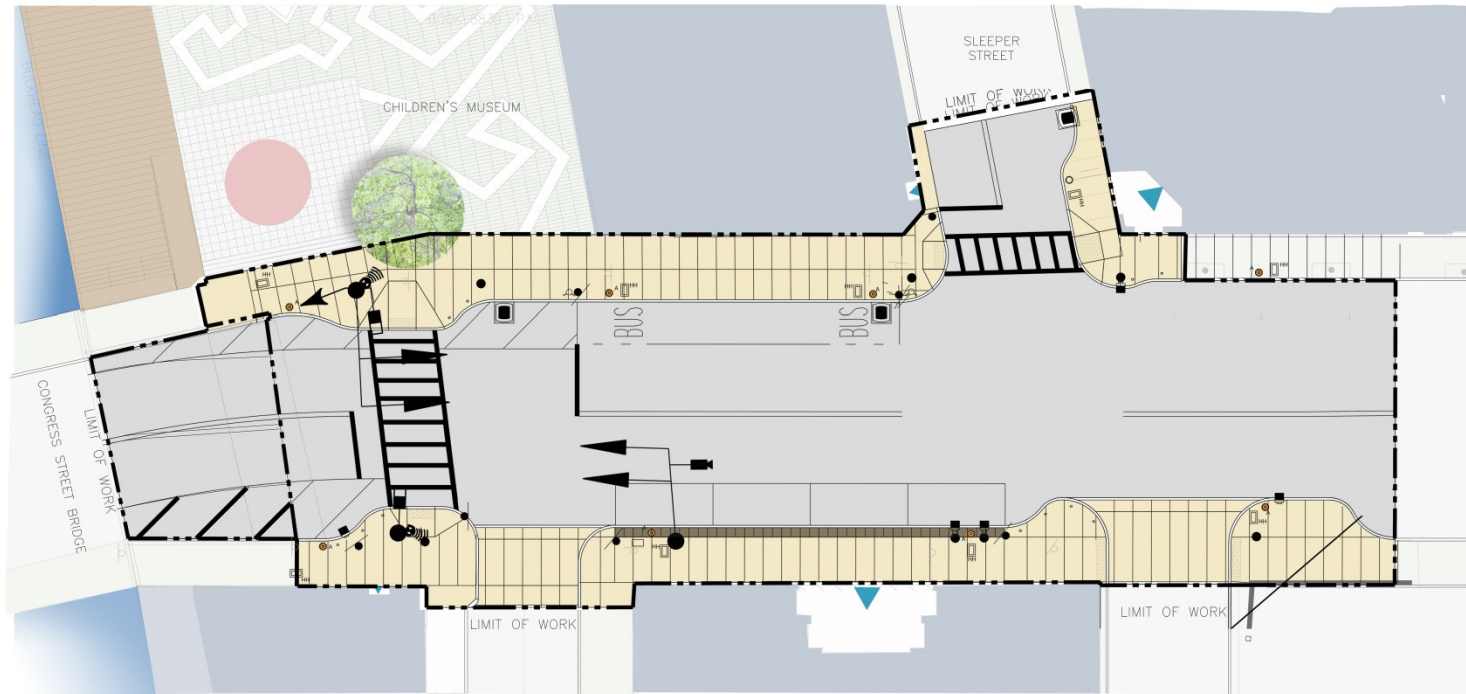



# Congress Street Intersection Section

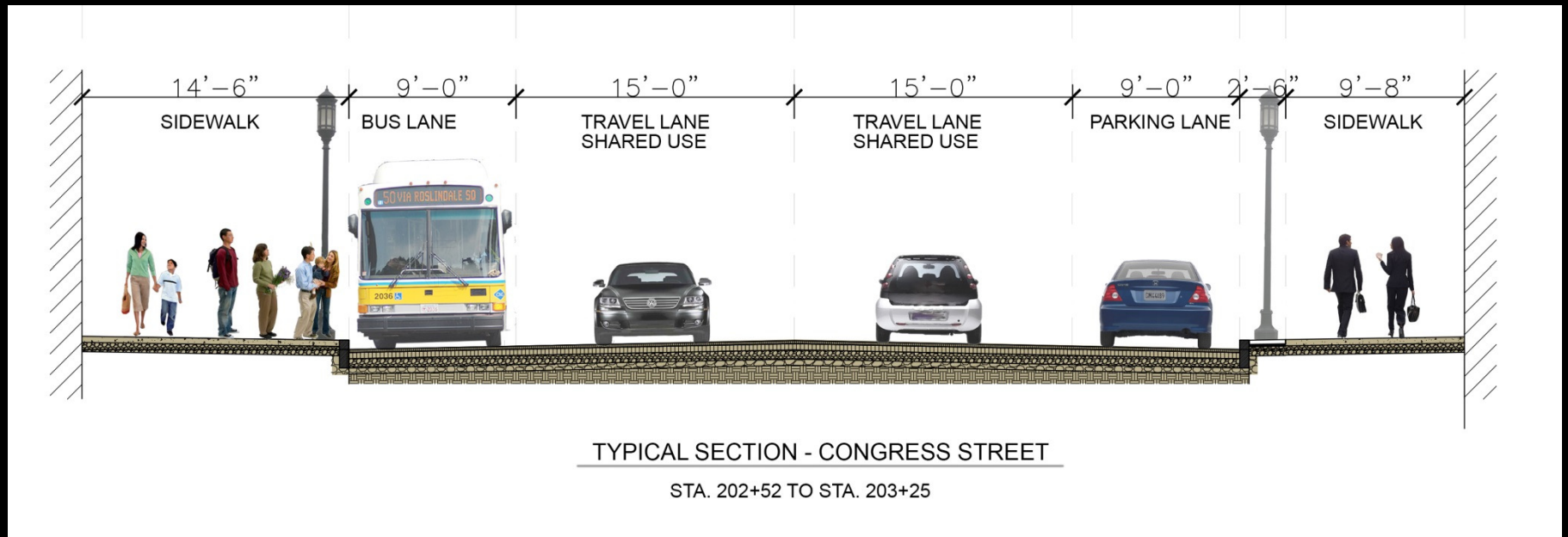

# Summer St. Improvements – Previous 25% Design

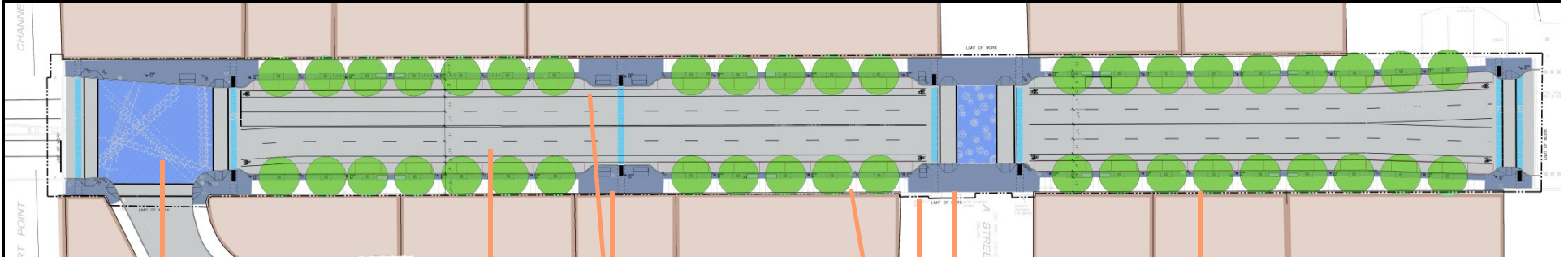

Crossings made shorter and highlighted with street imprint and lighting

Bumpouts for display screens or art

New striping, lighting, bike racks, and signals throughout

A Street Bridge crossing

Gathering areas and continuity strips with drainage detail

Paired street trees with openings at crossings and for future public art

# Boston Bicycle Plan

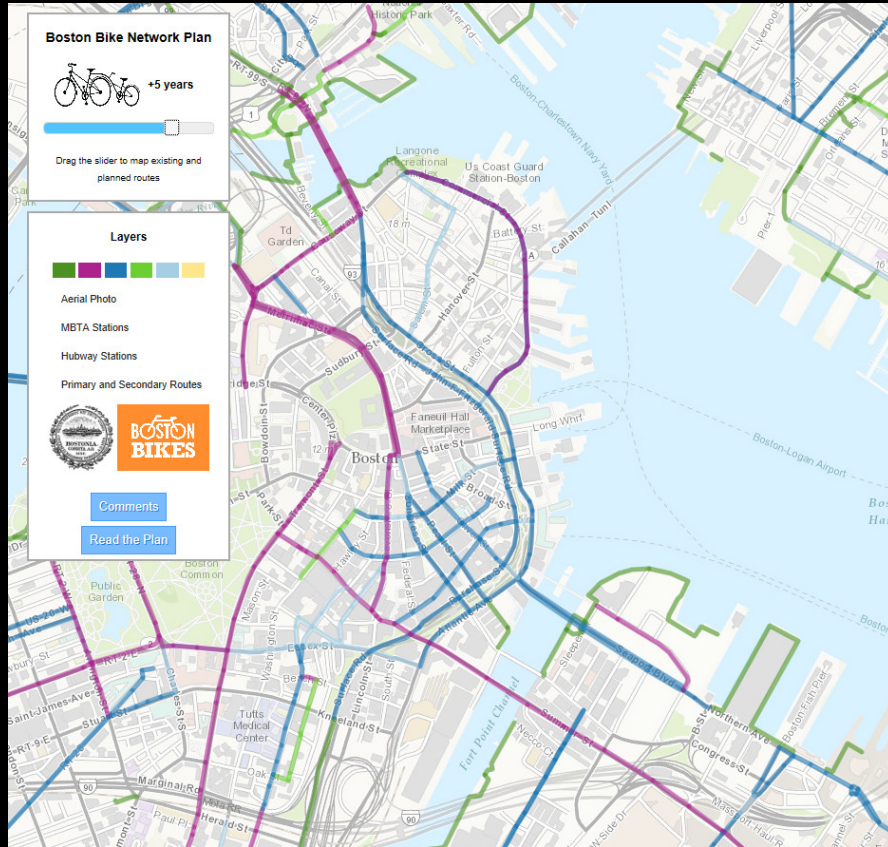

5 Years

C|S|S

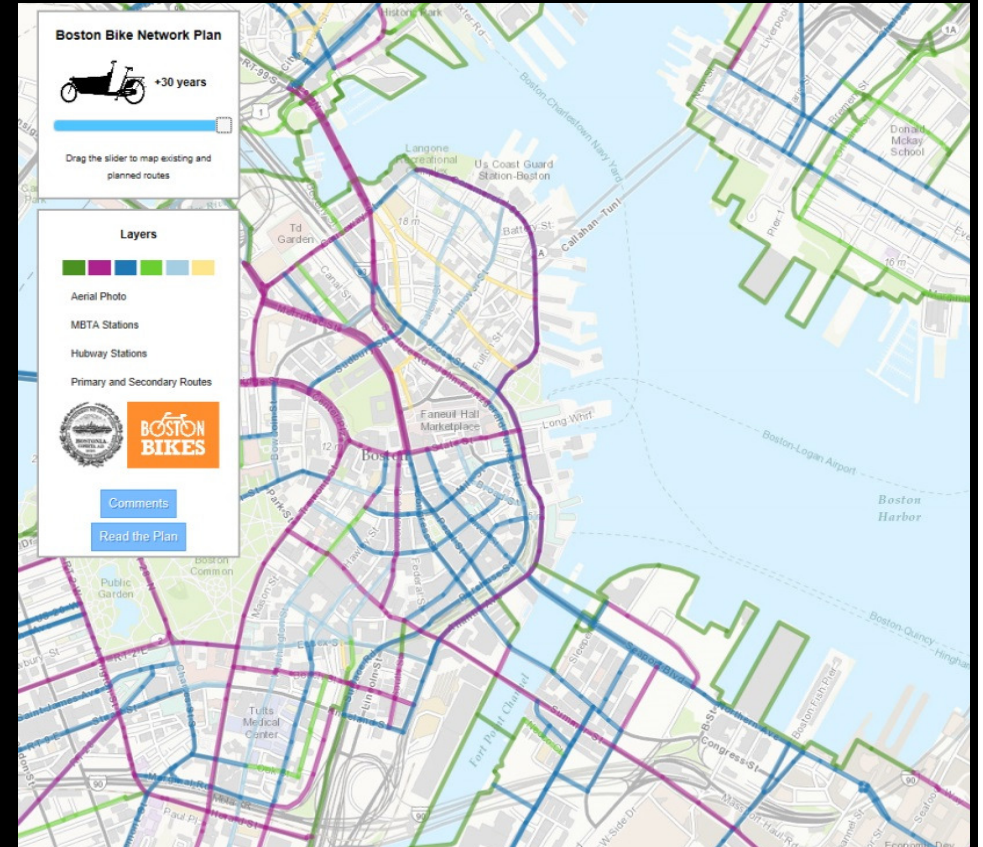

30 Years



# Summer St. Improvements – With Cycle Track

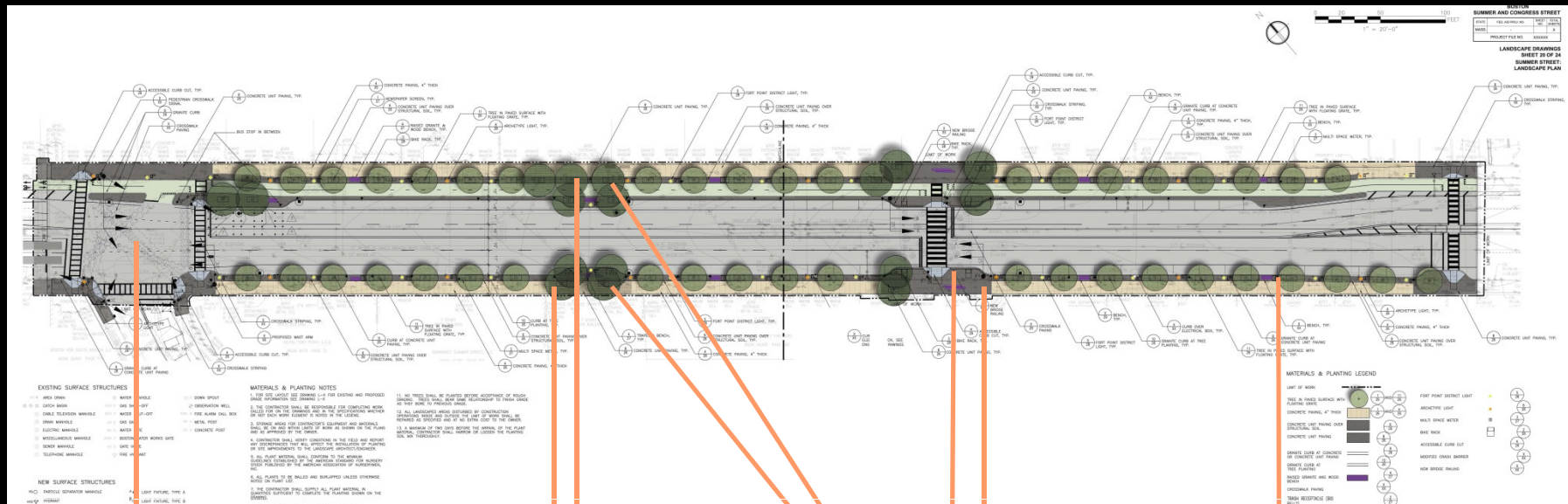

Crossings made shorter and highlighted with street imprint and possible lighting at intersection

Cycle Track added to previous design, bike lanes removed

A Street Bridge crossing  
Gathering areas

Grouped canopy trees, trees along length of street

New striping, lighting, bike racks, and signals throughout

# Summer Street Dimensions – With Cycle Track

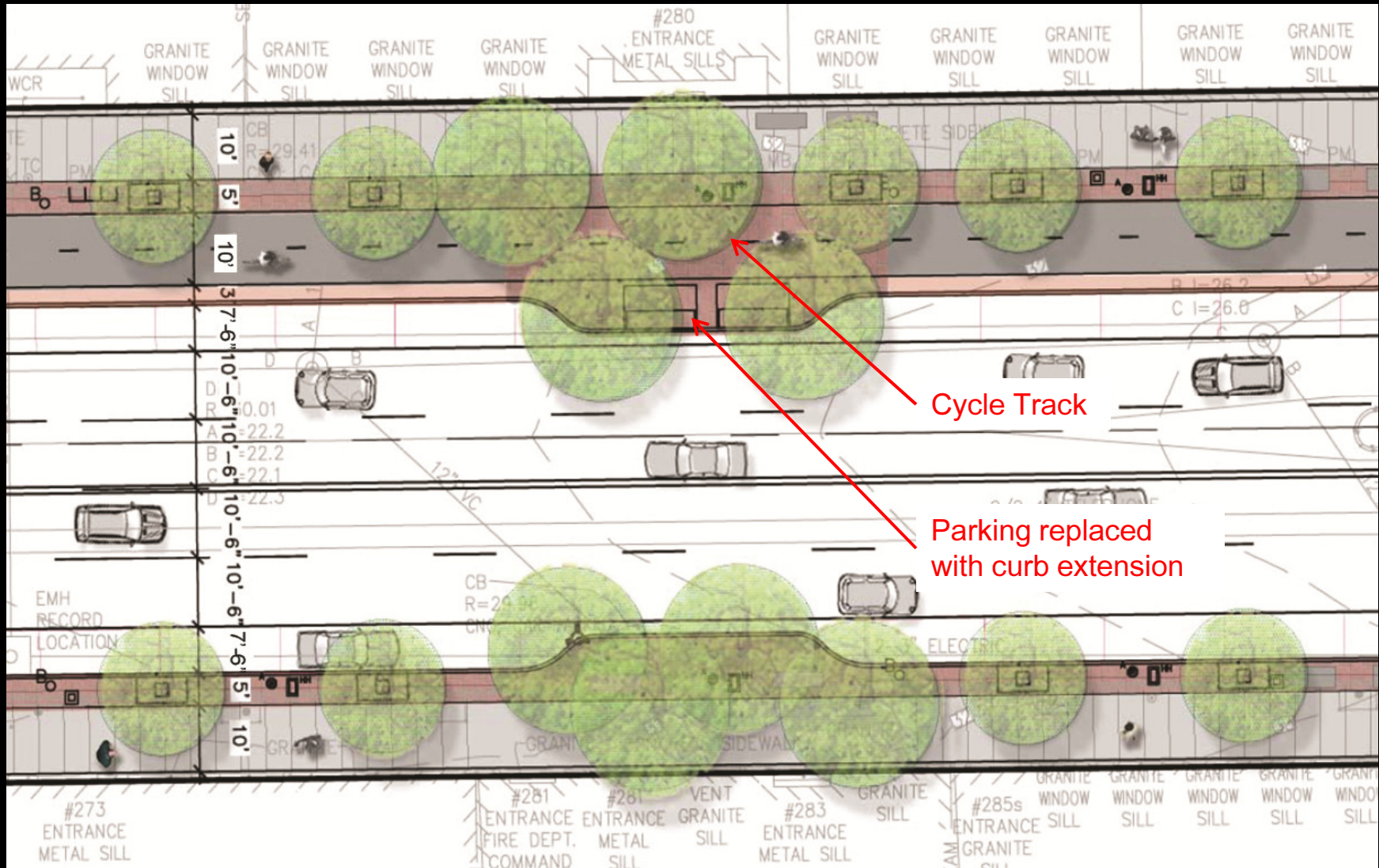



# Summer Street Typical Section – Looking East

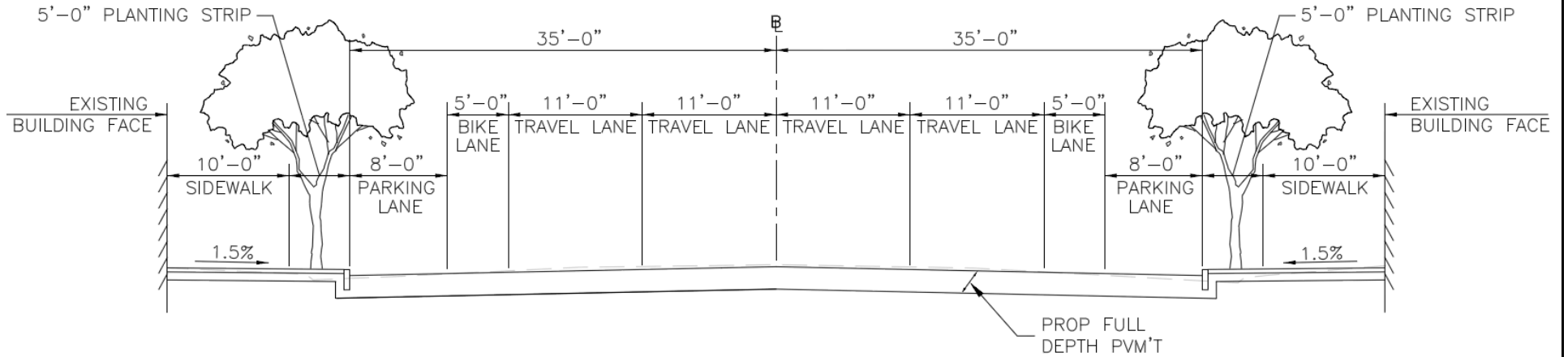

## Previous 25% Design

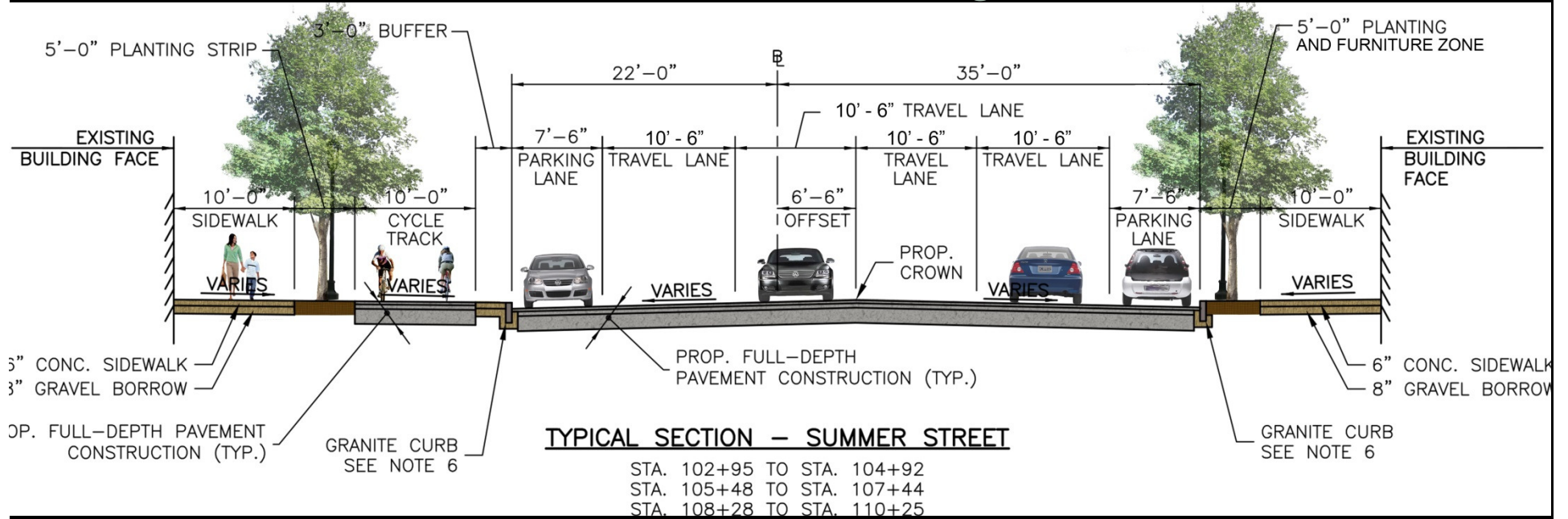

# Summer Street Section – With Cycle Track





# Street Furnishing Materials





# Street Furnishing Materials

