

# PARCEL P-12C

288-298 TREMONT STREET

BCDC  
11.19.2019



# Items to address

1. Complexity of Facades
2. Layout and Programming of Ground Plane
3. Library Planning

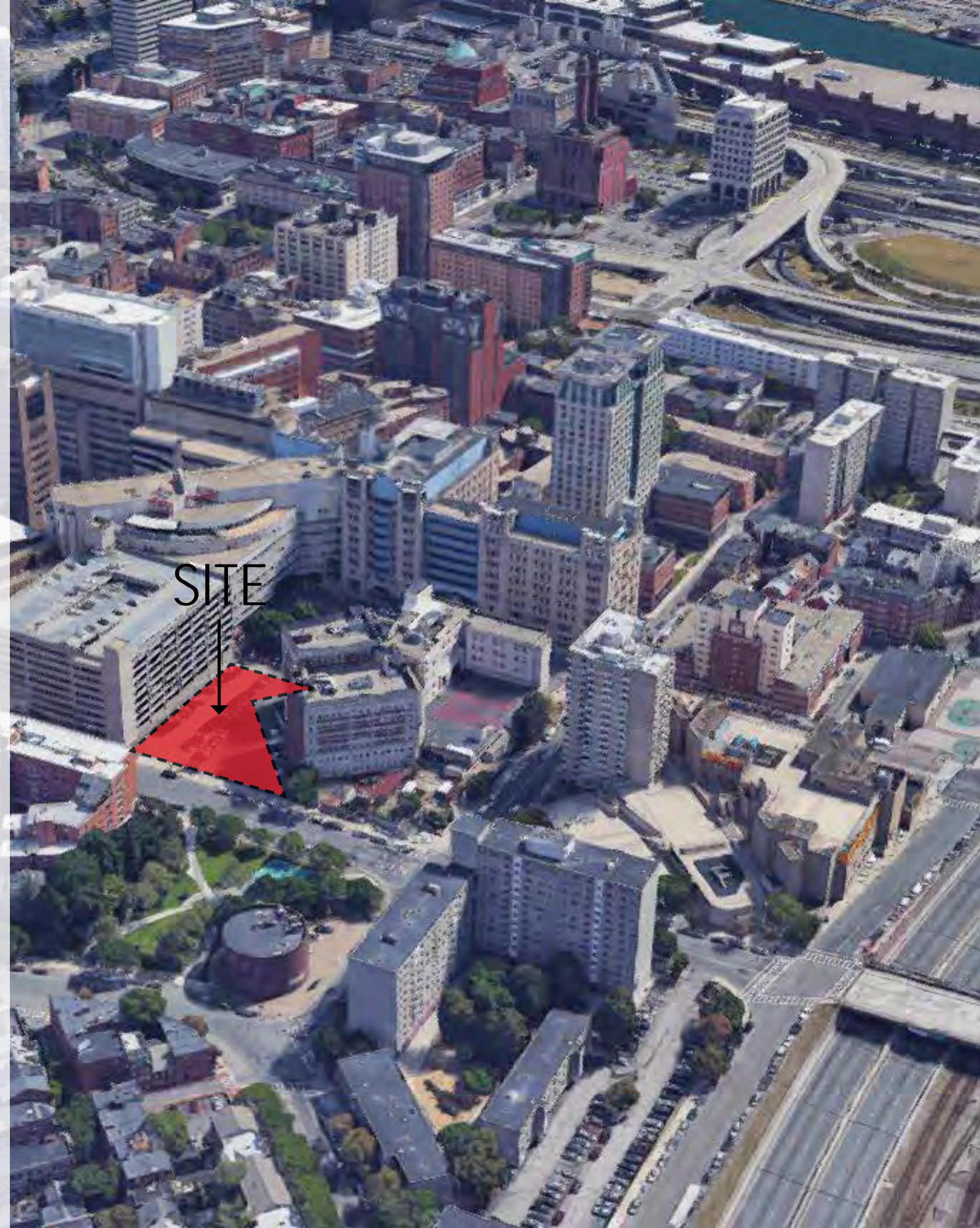

# ELEVATION PARTI DIAGRAMS

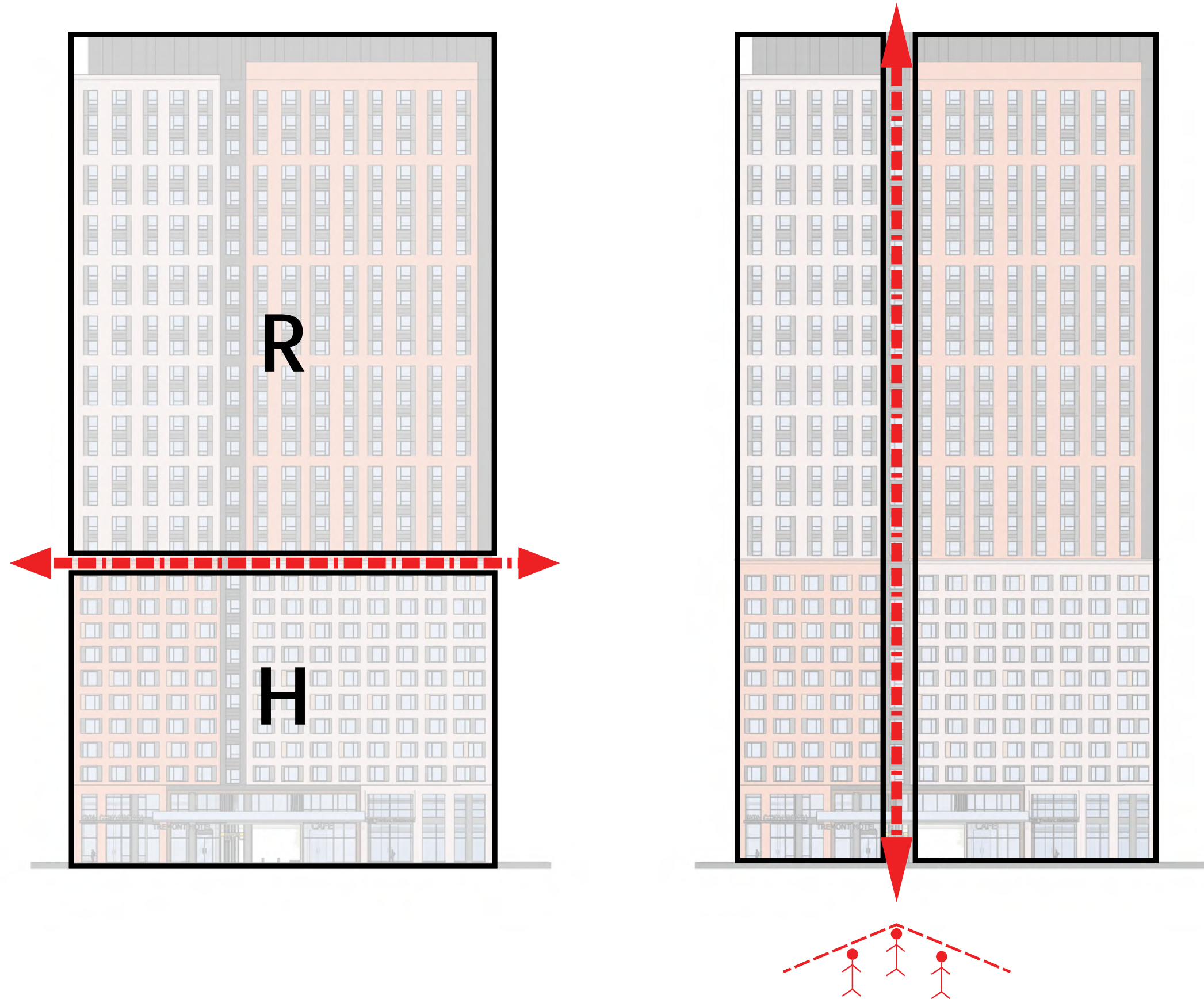

# ELEVATION COLOR OPTIONS

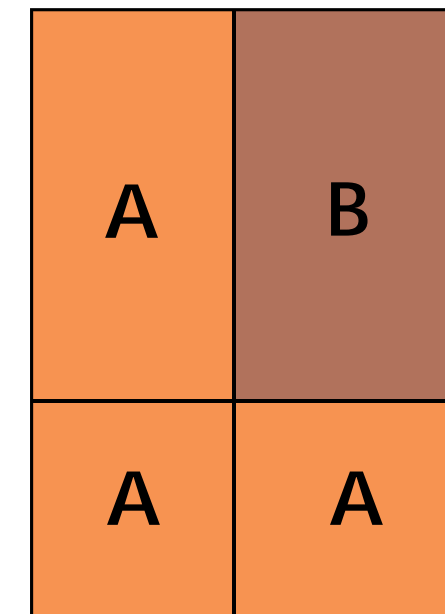
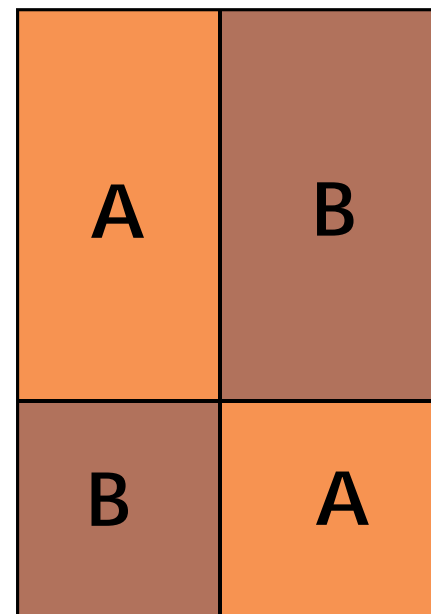
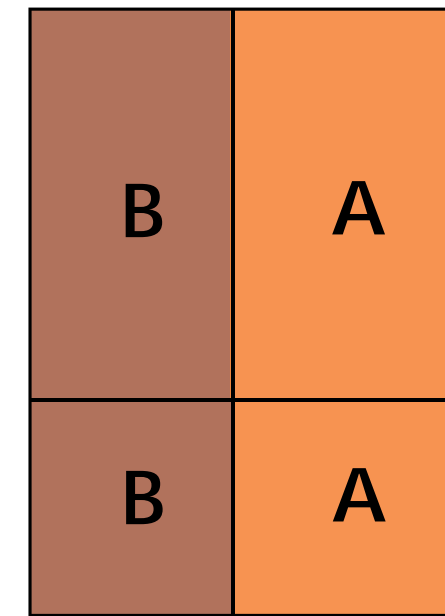
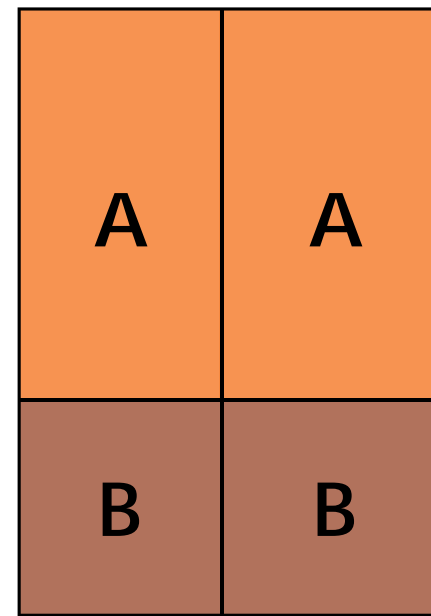
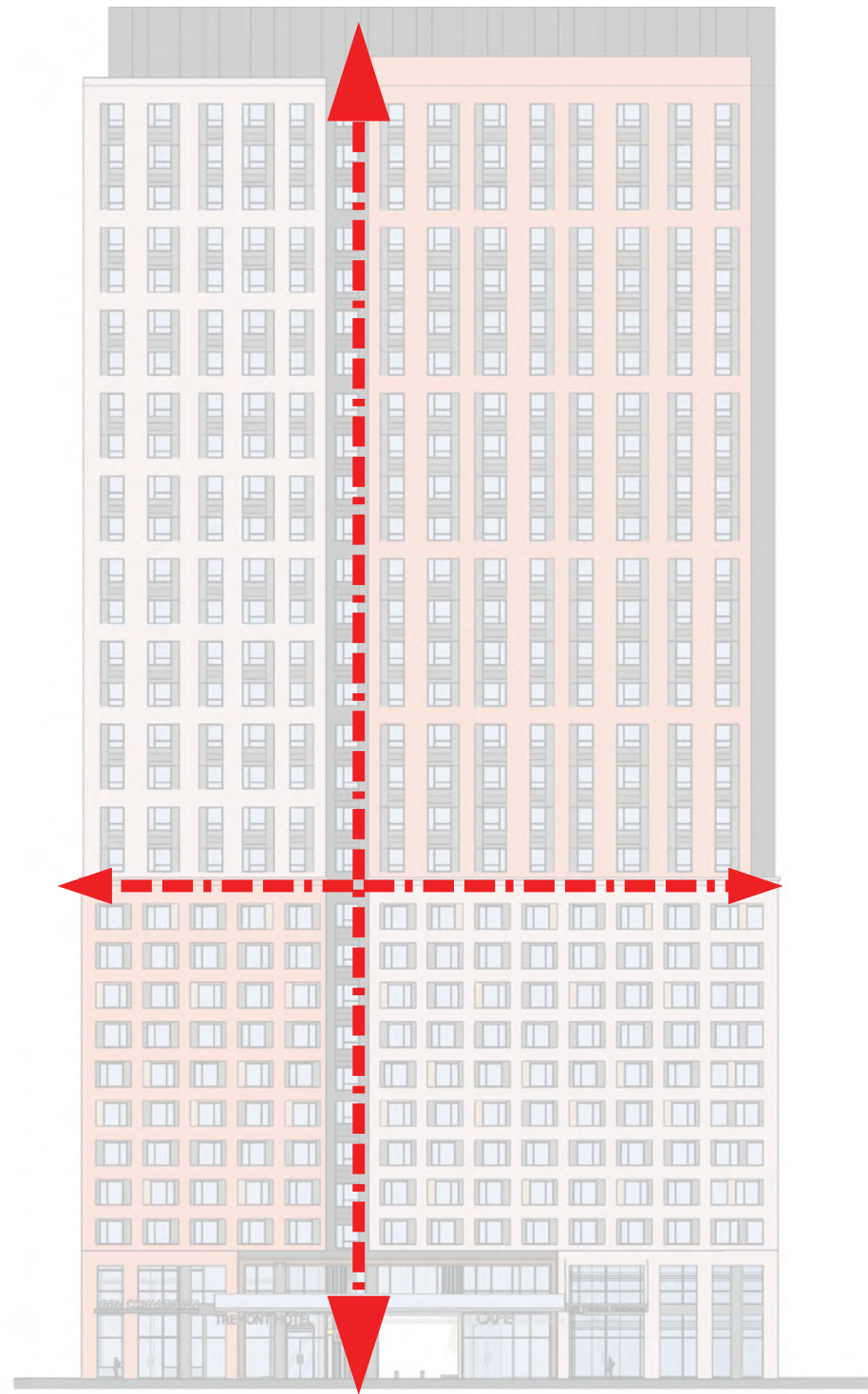

# ELEVATION WINDOW GROUPING STUDIES

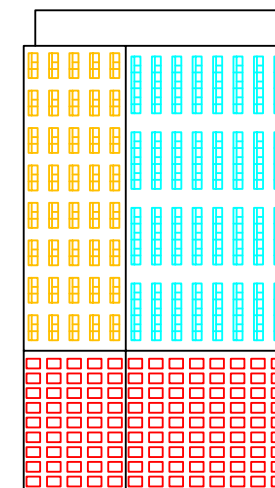
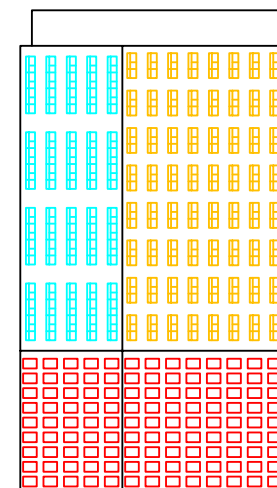
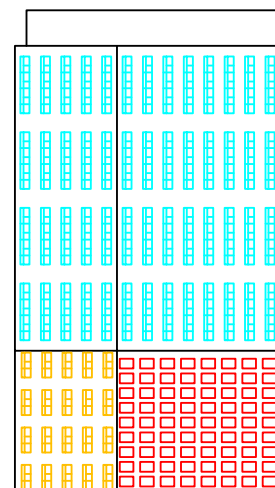
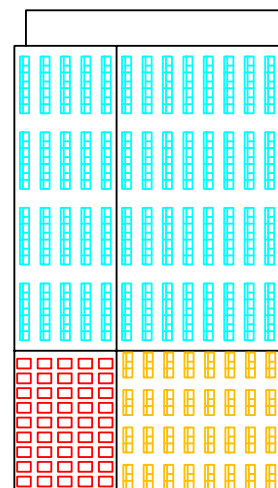
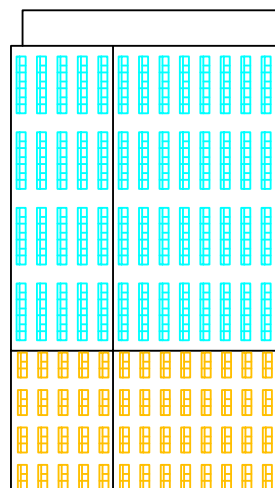
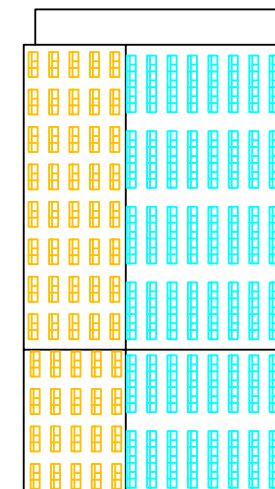
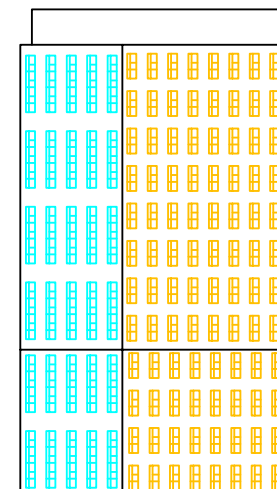
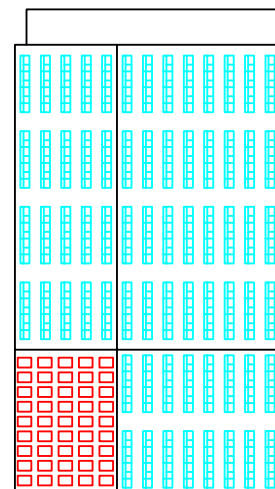
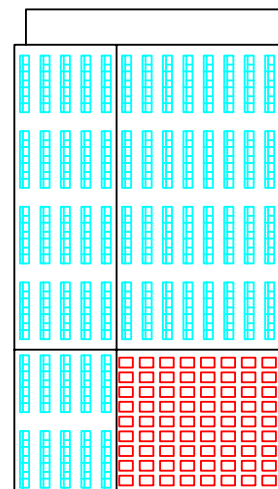
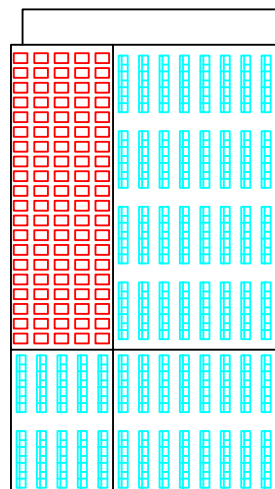
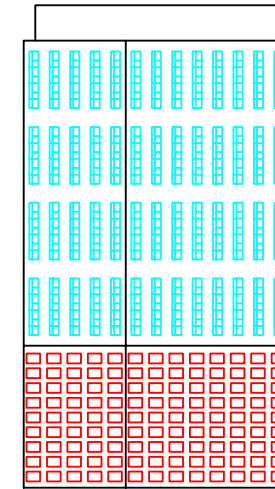
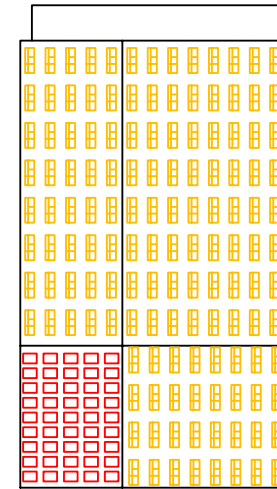
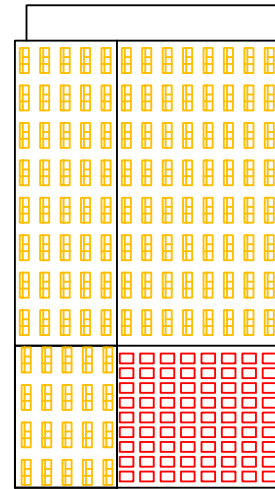
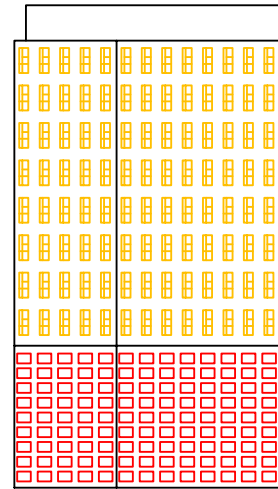
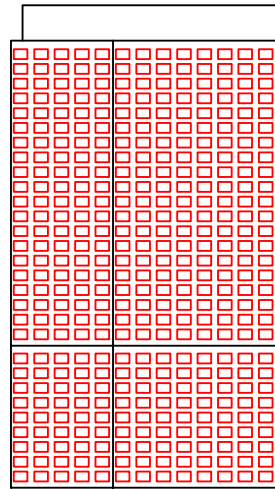

# CURRENT DESIGN



# OPTION 1



# OPTION 2





# OPTION 3



# OPTION 4A



# OPTION 4B



# COURTYARD DESIGN

## CURRENT GROUND FLOOR PLAN

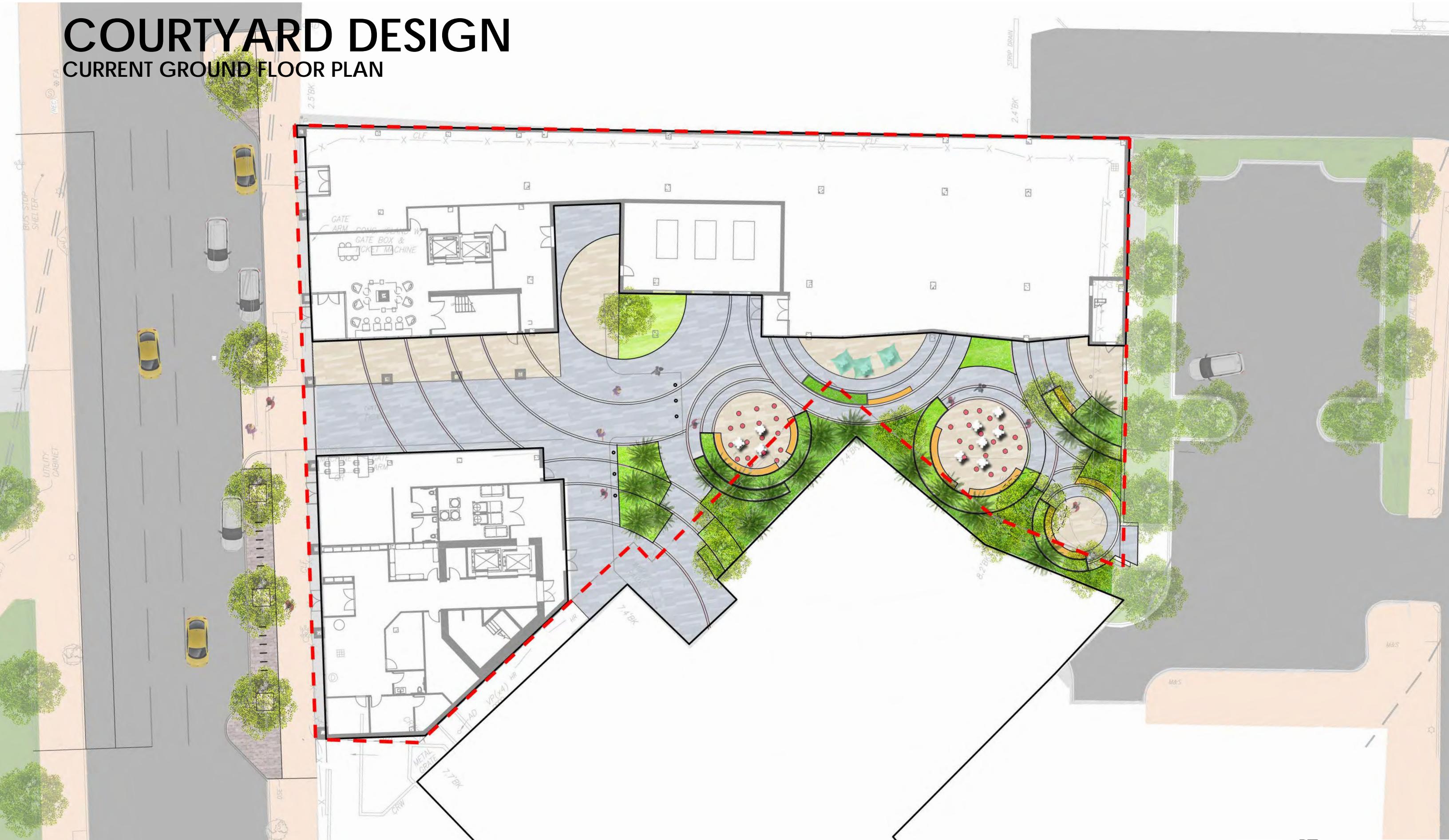



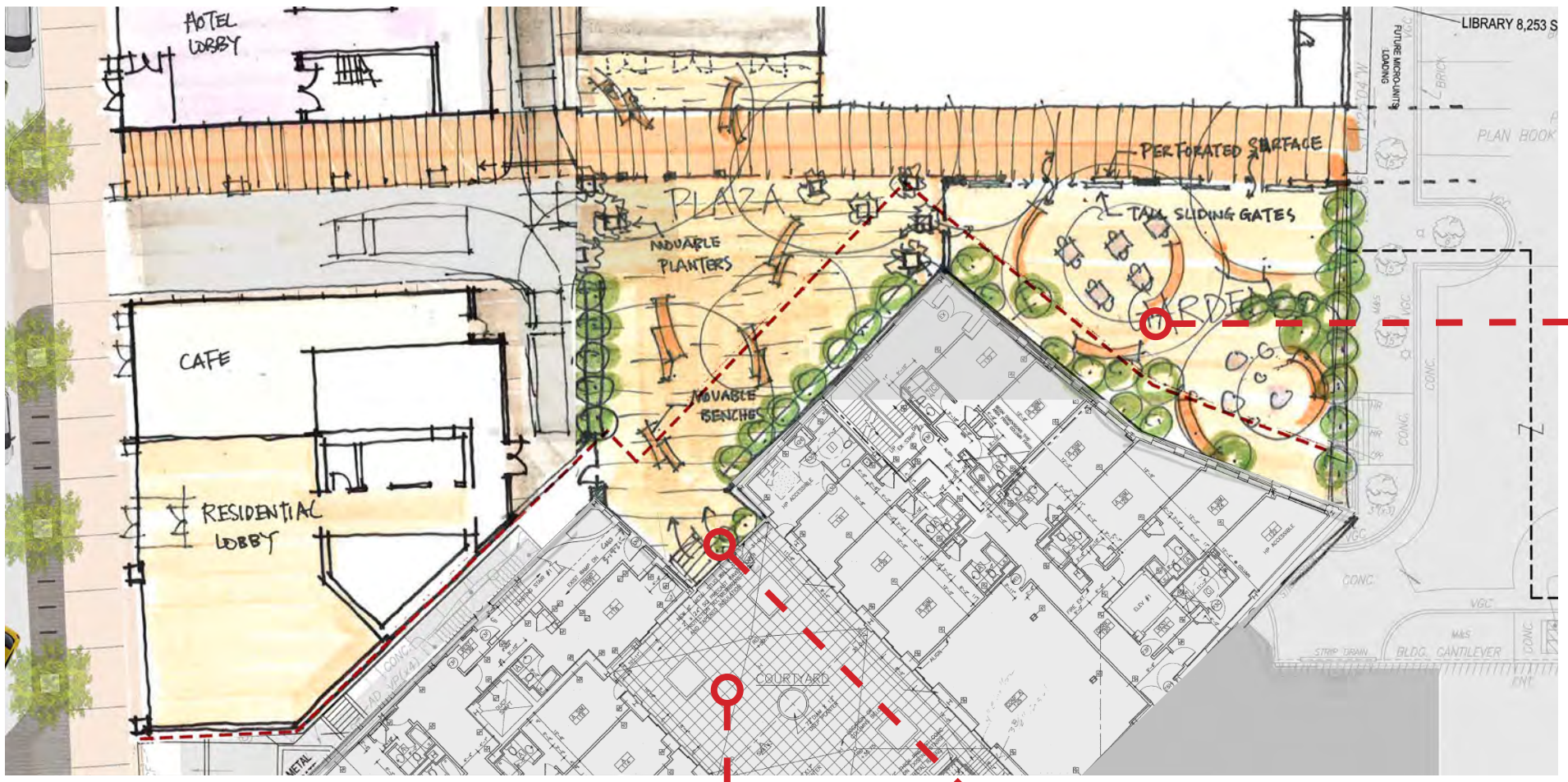

# COURTYARD DESIGN

ALT OPTION 2 - Plaza & Garden



VIEW FROM TREMONT STREET LOOKING TOWARDS THE INNER COURTYARD

THANK YOU

