

A NEW HOME FOR ROXBURY'S CREATIVE COMMUNITY



MBE



NEW ATLANTIC DEVELOPMENT



WBE

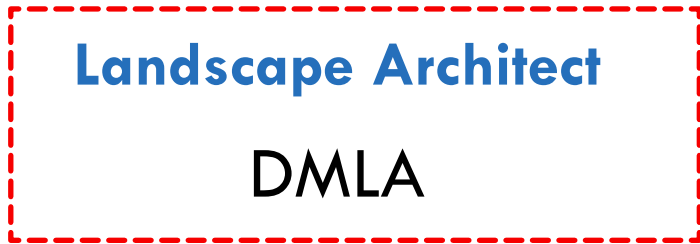

Attorney
Klein Hornig LLP

MBE

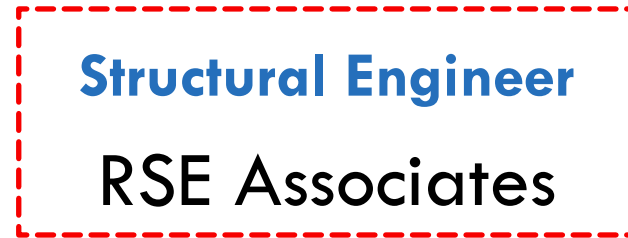

WBE



WBE



MEP Engineer
Norian / Siani
Engineering

Surveyor/Civil
Meridian
Associates (ESOP)

WBE



CONSTRUCTION JOBS

- Creation of 160 estimated FTE jobs
- 51% Boston residents, 51% minority, 15% female
- Walk on application system for local workers

HIRING AND OUTREACH

- Roxbury Builders Guild
- Dorchester/Roxbury Labor Committee
- Utilization of the Boston Residents Jobs Bank database
- Merit Apprenticeship Program (MAP) through ABC
- SLBE/MWBE Directory
- Mass Minority Contractors Association
- Project RIGHT Inc.
- Advertising in local papers

2147 WASHINGTON STREET

KAPLAN
CONSTRUCTION

Women Business Enterprise
(WBE)



D/R/E/A/M COLLABORATIVE
ARCHITECTURE | REAL ESTATE DEVELOPMENT



GOOD JOBS STANDARDS

- At Least 51% of Employee Workhours by Boston Residents
- At Least 51% of Employee Workhours by Minority Workers
- At Least 51% of Employee Workhours by Women
- Wages Above the Boston Living Wage
- At Least 75% of Employees Shall be Full-Time
- All Full-Time Employees Offered Opportunity for Company-Sponsored Healthcare



64 ALPINE STREET



BARTLETT LOT D



24 WESTMINSTER AVE



HIBERNIAN HALL



BLESSED SACRAMENT



ART BLOCK

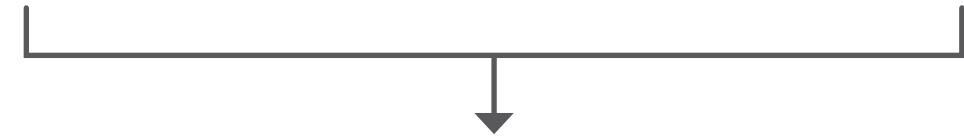
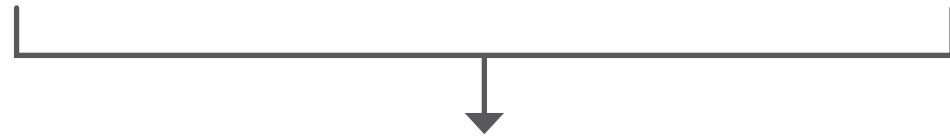

D/R/E/A/M
COLLABORATIVE
ARCHITECTURE | REAL ESTATE DEVELOPMENT



NEW ATLANTIC
DEVELOPMENT



- Unparalleled dedication to the Roxbury community
- Decades of experience creating affordable and mixed-use housing
- Strong relationships with community leaders, DND, BPDA and DHCD
- Commitment to creating development without displacement

2147 WASHINGTON STREET

D/R/E/A/MCOLLABORATIVE
ARCHITECTURE | REAL ESTATE DEVELOPMENT



62 rental units & 12 condominium units will be affordable to households earning a wide range of incomes, starting below 30% of AMI.

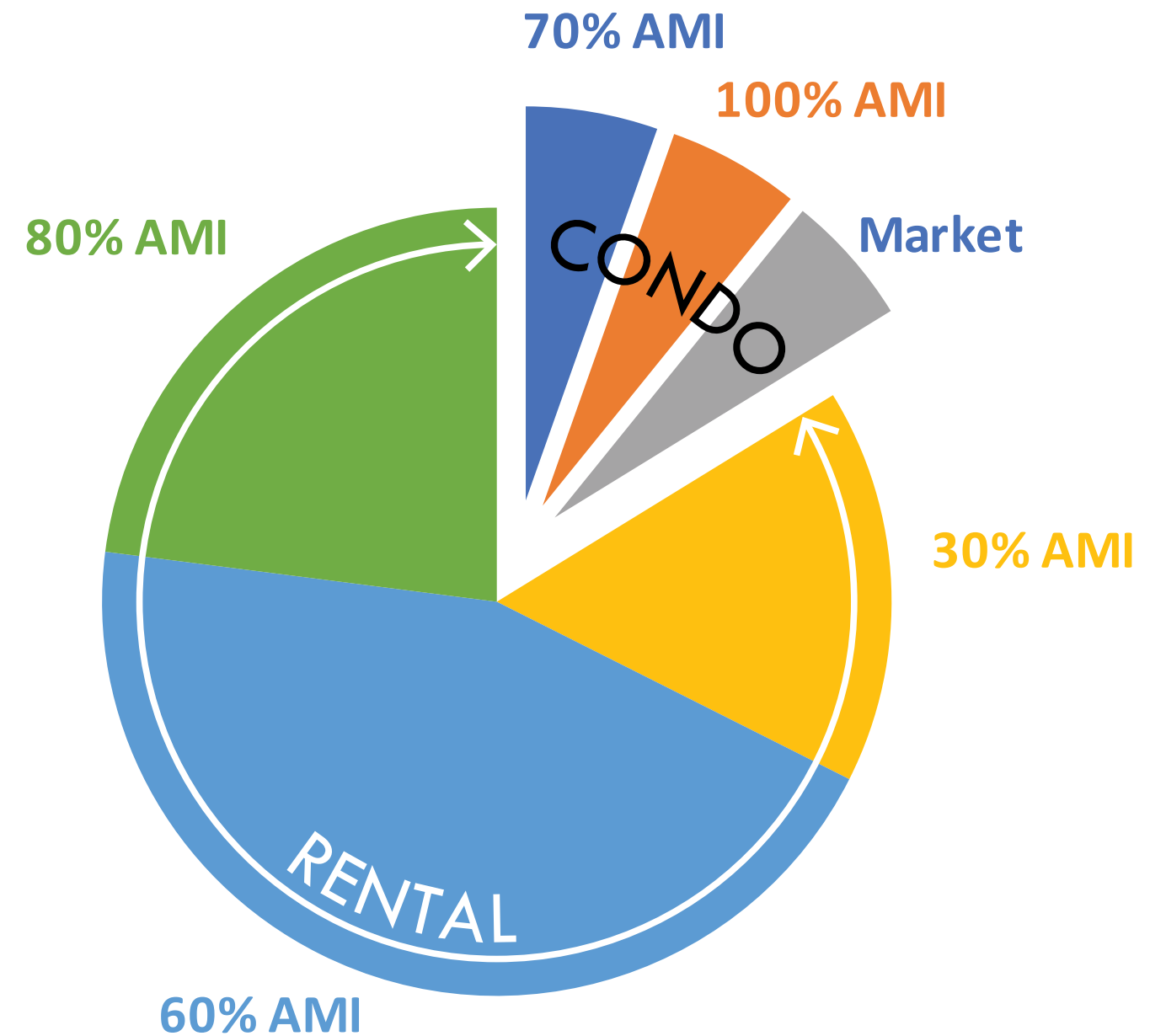
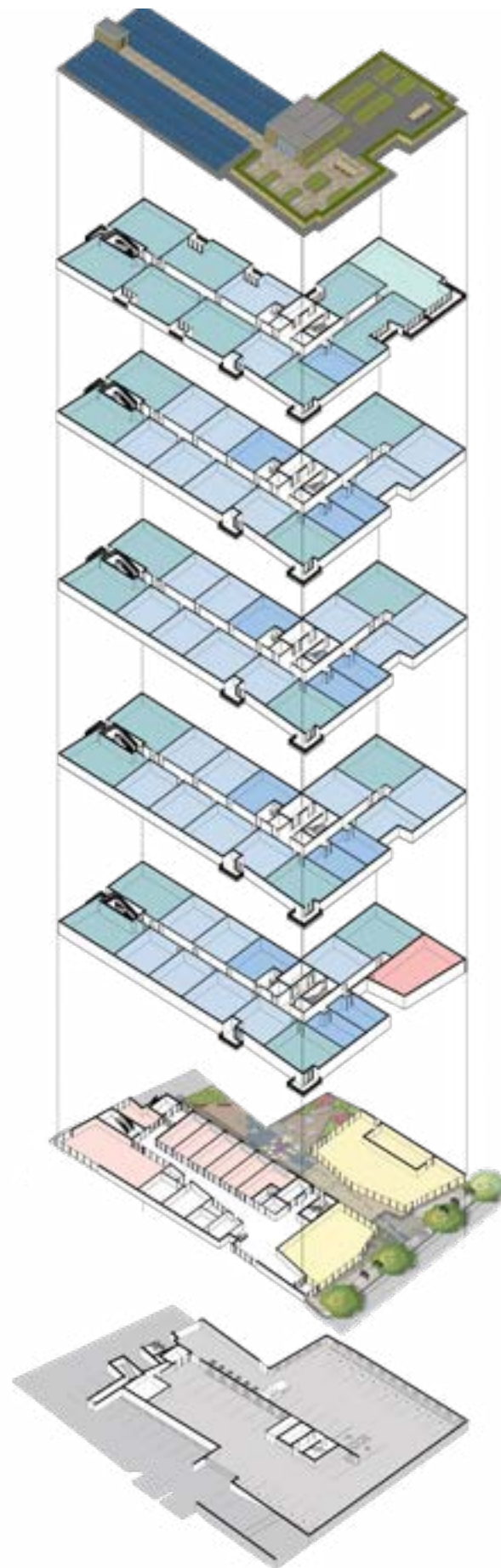

2147 WASHINGTON STREET



MELNEA HOTEL & RESIDENCES

TROPICAL PARCEL 10

BOLLING BUILDING

75 DUDLEY ST

2154 WASHINGTON

BLAIR LOT

10 TABER ST

40 WARREN ST

135 DUDLEY ST

2147 WASHINGTON STREET

Figure 2. *On-street Parking*

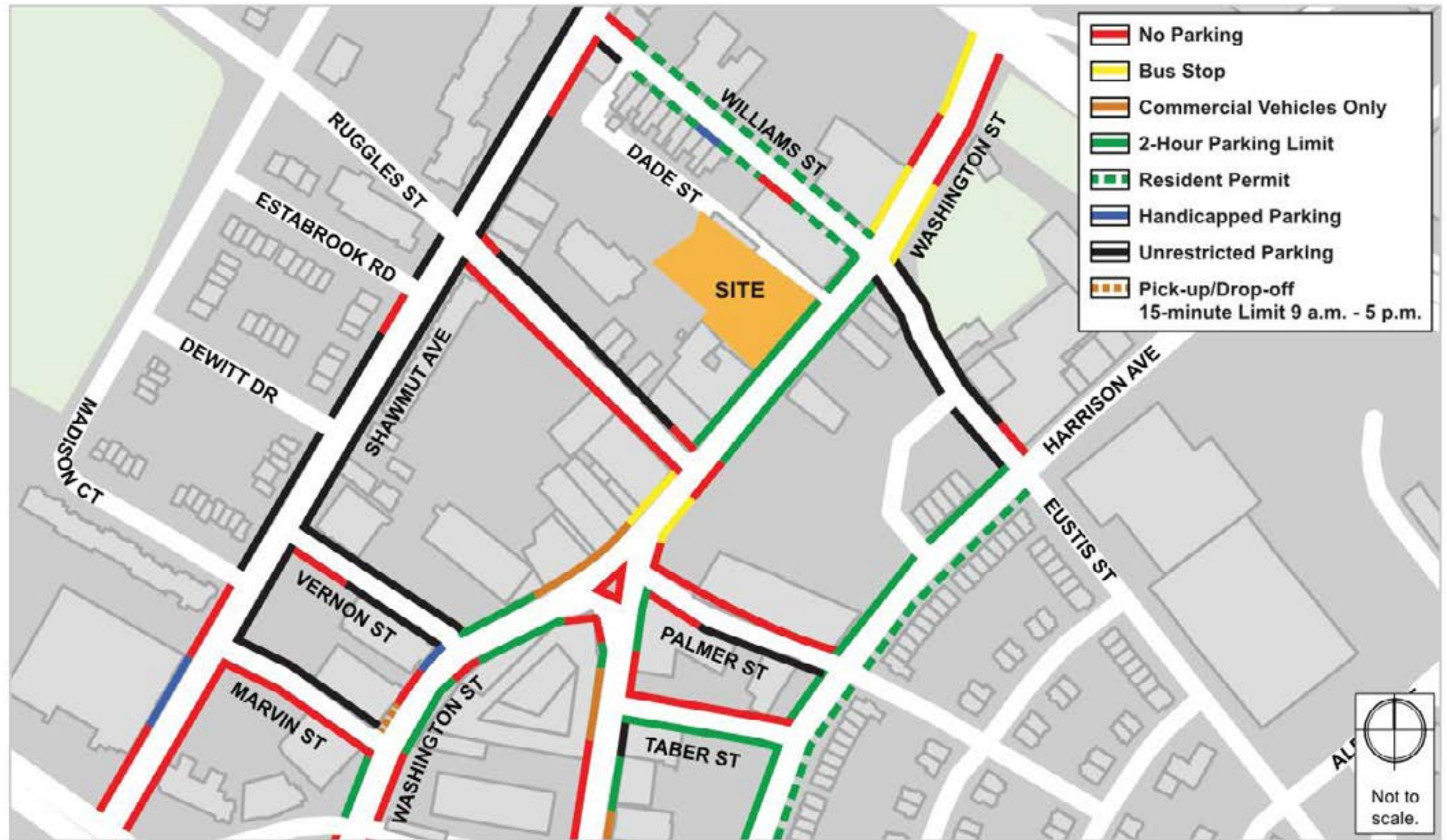



2147 WASHINGTON STREET

D/R/E/A/M COLLABORATIVE
ARCHITECTURE | REAL ESTATE DEVELOPMENT





2147 WASHINGTON STREET

D/R/E/A/M COLLABORATIVE
ARCHITECTURE | REAL ESTATE DEVELOPMENT





2147 WASHINGTON STREET

D/R/E/A/M COLLABORATIVE
ARCHITECTURE | REAL ESTATE DEVELOPMENT



CONTEXTUAL BUILDINGS



2147 WASHINGTON STREET

D/R/E/A/M COLLABORATIVE
ARCHITECTURE | REAL ESTATE DEVELOPMENT



MASONRY

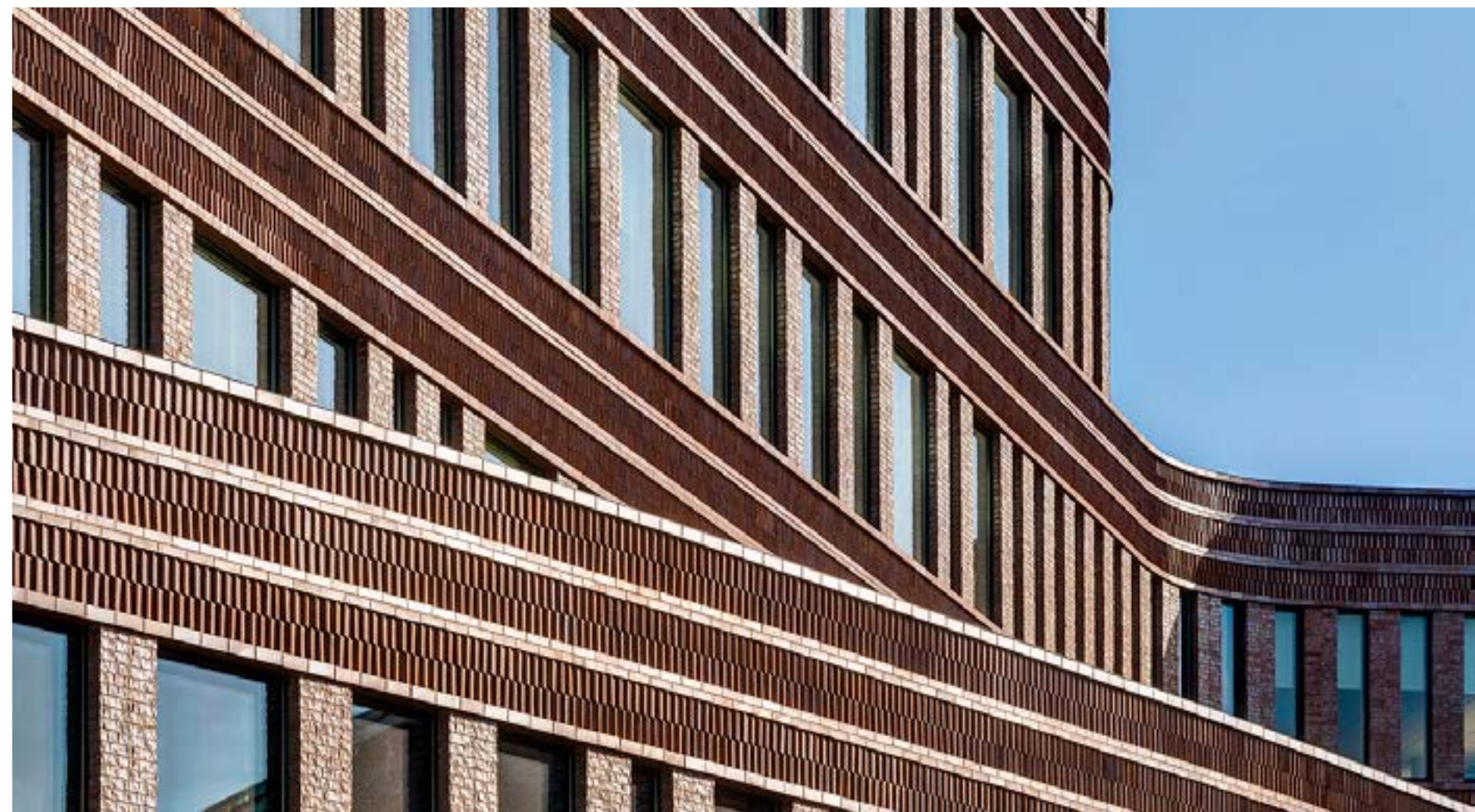

2147 WASHINGTON STREET

D/R/E/A/M COLLABORATIVE
ARCHITECTURE | REAL ESTATE DEVELOPMENT



METAL PANEL



2147 WASHINGTON STREET

D/R/E/A/M COLLABORATIVE
ARCHITECTURE | REAL ESTATE DEVELOPMENT





2147 WASHINGTON STREET

D/R/E/A/M COLLABORATIVE
ARCHITECTURE | REAL ESTATE DEVELOPMENT





2147 WASHINGTON STREET

D/R/E/A/M COLLABORATIVE
ARCHITECTURE | REAL ESTATE DEVELOPMENT





2147 WASHINGTON STREET



D/R/E/A/M COLLABORATIVE
ARCHITECTURE | REAL ESTATE DEVELOPMENT



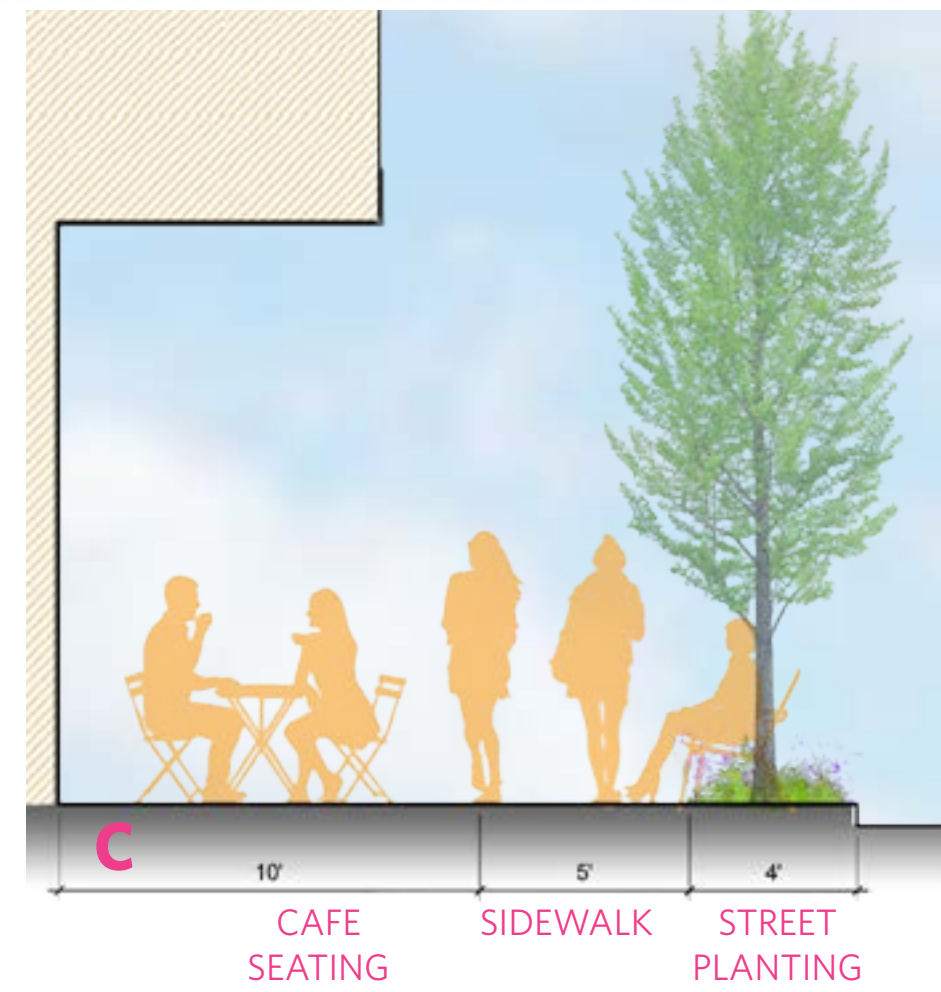
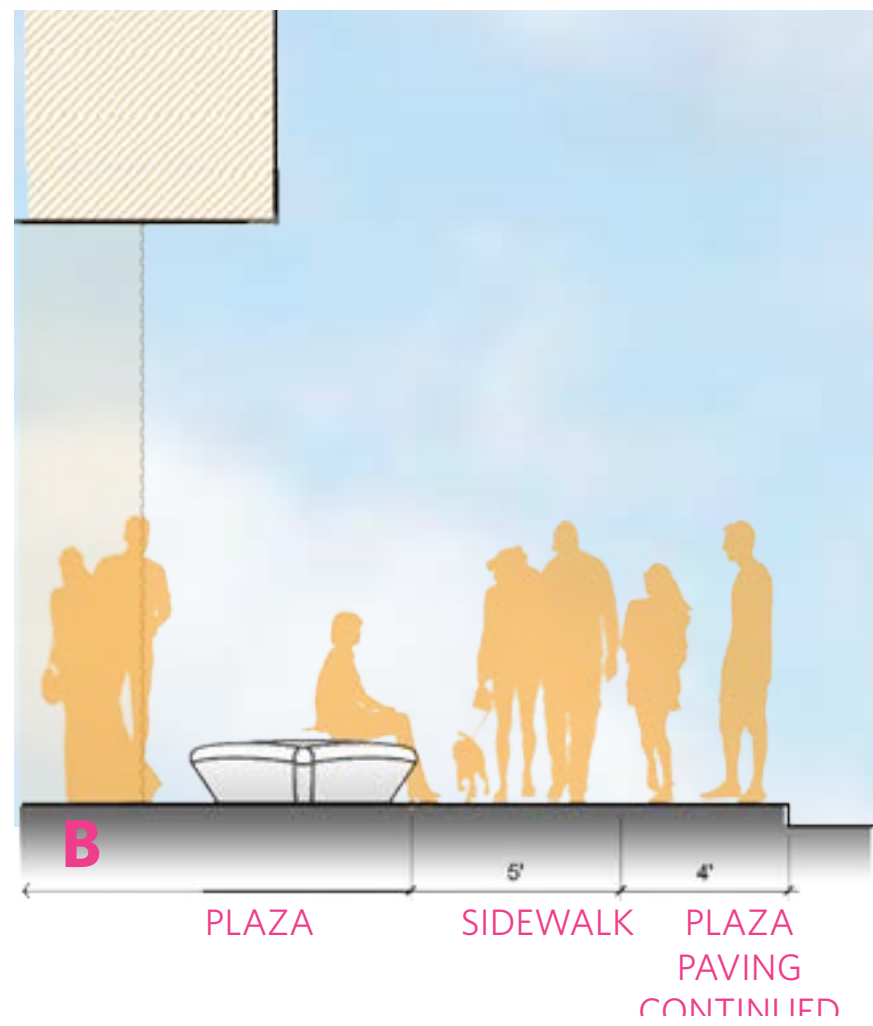
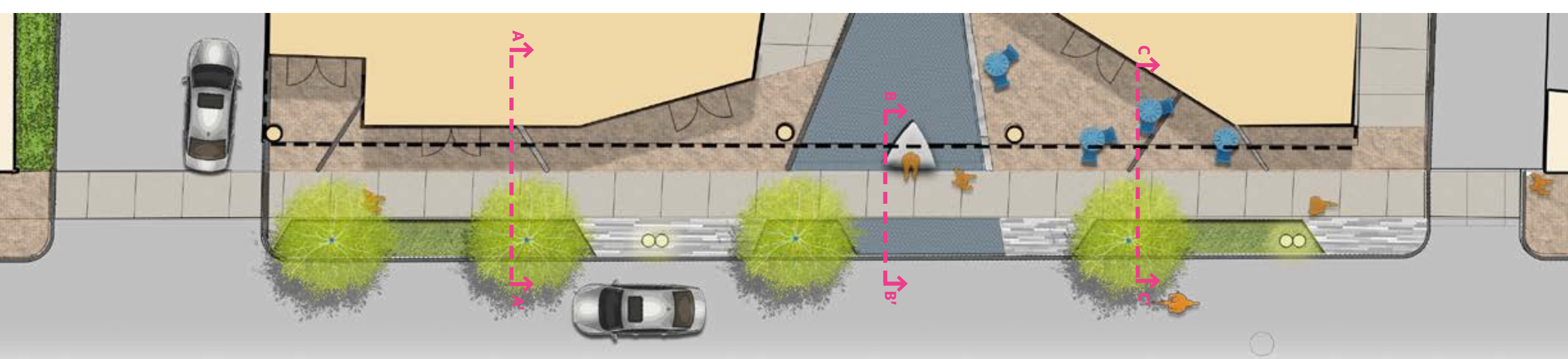

2147 WASHINGTON STREET