

Zoning Districts City of Boston
Map 1D
Huntington Avenue/Prudential Center District
 (Supplemental to "Map 1, Boston Proper")

Adopted by the
 Zoning Commission of the City of Boston
 in meeting on February 22, 1990

Richard B. Kurland
Chairman
 Effective: March 20, 1990
 Date of public notice: February 10, 1990
 (see St. 1956, c. 665, s.5)

As amended
 Effective: October 26, 2021
 Public notice: September 23, 2021

DISCLAIMER

The Boston Zoning Maps, printed, or downloaded from the City of Boston Planning Department website (bostonplans.org) may not reflect the most current Maps adopted by the Boston Zoning Commission. The print versions of the Maps as approved and signed by the Zoning Commission, available at the City of Boston Planning Department for download as a PDF, remain the official versions of the Maps. Thus, if discrepancies exist between the official print and Internet versions of these Maps, the official print version shall be considered correct. For further information regarding the official version of the Boston Zoning Code, including both the text and maps, please consult the City of Boston Planning Department.

		As-of-Right Maximum Height	Floor Area Ratio (FAR)
1	St. Botolph Street Protection Area*	45'	2
2	St. Germain Street Protection Area*	45'	2
3	Massachusetts Avenue/Belvidere Street Protection Area*	45'-75' See Section 41-5.3.	2-4
4	General Area	155'	10
5	Christian Science Institutional Area	75'-115' See Section 41-7.	2
6	St. Cecilia Special Study Area	65'-100' See Section 41-9.	4-7
7	Huntington Avenue Boulevard District	115' See Section 41-8.	8
OS-A	Air-Right Open Space Subdistrict	See Section 33-16	
PDA I		See Section 41-12.2	
PDA II		See Section 41-12.2	
PDA III		See Section 41-12.2	
PDA IV		See Section 41-12.2	
PDA V		See Section 41-12.2	

* Each Protection Area constitutes a Restricted Roof Structure District, subject to Sections 16-8 and 41-6.

See additional provisions in Article 41.

Huntington Avenue/Prudential Center District is within the Restricted Parking (Overlay) District.

Huntington Avenue/Prudential Center District is within the Groundwater Conservation Overlay District.

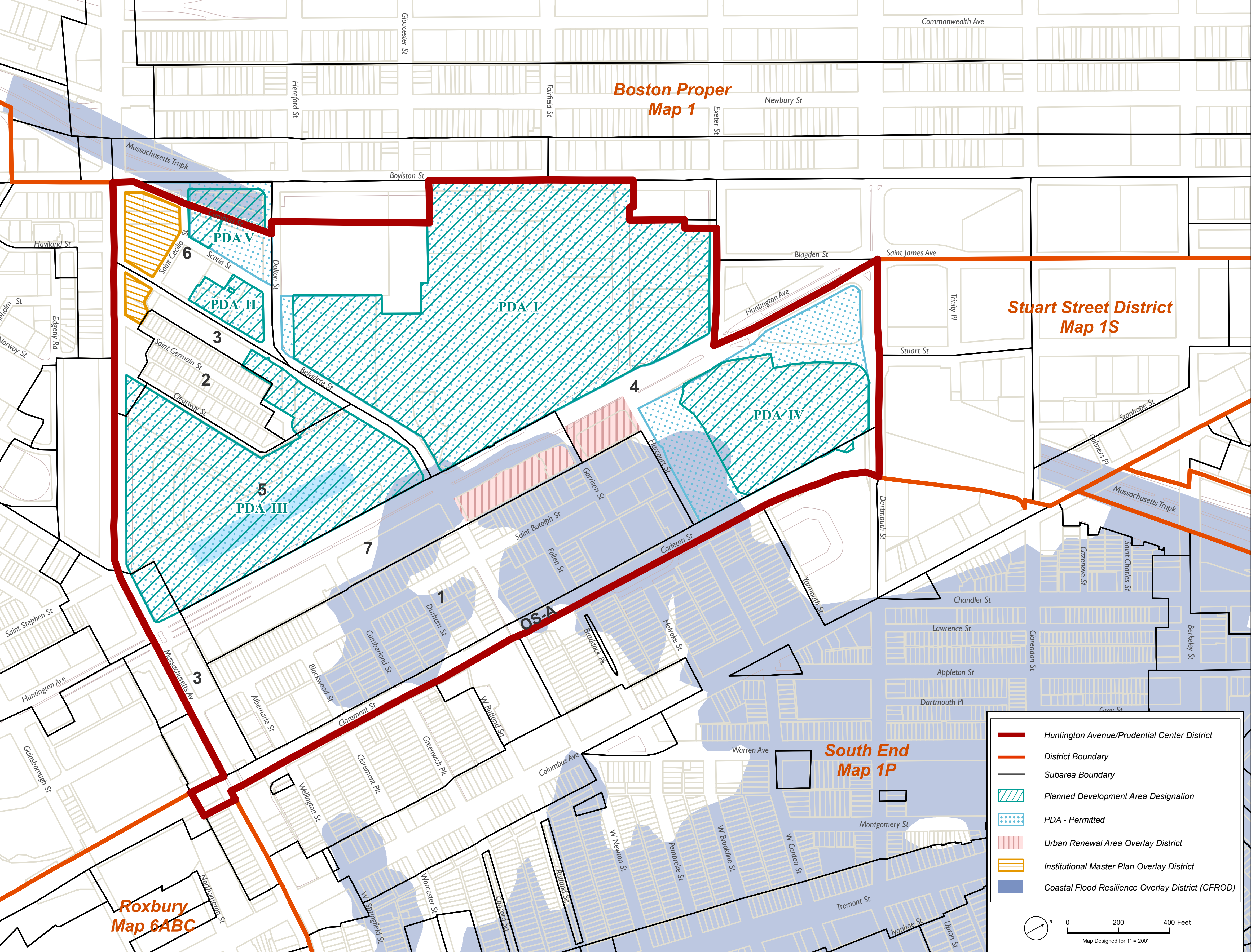

- Huntington Avenue/Prudential Center District
- District Boundary
- Subarea Boundary
- Planned Development Area Designation
- PDA - Permitted
- Urban Renewal Area Overlay District
- Institutional Master Plan Overlay District
- Coastal Flood Resilience Overlay District (CFROD)

